

Tender ID –NIT/RBO3/AO6/01/2024-25



**TENDER DOCUMENT**

**E – TENDERING WITH REVERSE AUCTION**

**INTERIOR FURNISHING WORKS, ELECTRICAL AND  
ALLIED WORKS AND AIR  
CONDITIONING WORKS - RENOVATION**

**FOR**

**SBI ACB MURADNAGAR BRANCH  
(CODE :05888), GHAZIABAD**

<b>CLIENT:</b>	<b>ARCHITECTS:</b>
<b>STATE BANK OF INDIA REGIONAL BUSINESS OFFICE – 3 AO-6 1ST FLOOR , NAVYUG MARKET GHAZIABAD -201001.</b>	<b>MOHAN AND ASSOCIATES 201, PADMA TOWER RAJENDRA PLACE NEW DELHI – 110 008. TEL:- 91-7290056346</b>

**INDEX**

<b>S. NO.</b>	<b>DESCRIPTION</b>	<b>PAGE NOS.</b>
1.	NOTICE INVITING TENDERS	3 – 4
2.	INSTRUCTIONS TO THE TENDERERS	5 – 7
3.	FORM OF TENDER	8 - 9
4.	ARTICLES OF AGREEMENT	10– 13
5.	GENERAL CONDITIONS OF CONTRACT	14 – 28
6.	SPECIAL CONDITIONS OF CONTRACT	28 – 31
7.	SPECIFICATIONS (INTERIORS)	31 - 35
8.	SPECIFICATIONS (ELECTRICALS)	36 - 62
9.	SAFETY CODE	63
10.	PROFORMAS	64 – 68
11.	LIST OF APPROVED MAKES (INTERIORS)	69
12.	LIST OF APPROVED MAKES (ELECTRICALS)	70
13.	BILL OF QUANTITIES	71
14.	TENDER DRAWING	72
15.	SAMPLE BUSINESS RULE DOUCMENT	73-75

Tender ID- NIT/RBO3/AO6/01/2024-25

## STATE BANK OF INDIA

### Notice Inviting Tenders

State Bank of India invites **ONLINE E-TENDERS With REVERSE AUCTION** from the Bank's empaneled contractors Delhi circle for the category COMPOSITE WORKS from **Rs.25Lacs to up to Rs.50Lacs and above** Composite Interior, Electrical, & Allied Work For **SBI ACB MURADNAGAR BRANCH** At Ghaziabad.

1	Name of Work	:	COMPOSITE INTERIOR, ELECTRICAL, & ALLIED WORK FOR SBI ACB MURADNAGAR BRANCH AT GHAZIABAD
2	Time allowed for completion	:	<b>30Days</b> from the date of handing over of the site.
3	Earnest Money Deposit	:	<b>Rs.58457.00/- (Fifty Eight thousand, Four hundred Fifty seven rupees only )</b> by crossed Bank Draft / Banker's Cheque drawn in favour of STATE BANK OF INDIA, New Delhi. <b>(To be enclosed in sealed envelope as a part of technical Bid)</b>
4	Initial Security Deposit	:	2% of the total value of the contract including Earnest Money.
5	Last date and time of receipt of Tenders	:	<b><u>04<sup>th</sup> NOVEMBER 2024 up to 03.30 pm</u></b>
6	Address at which the tenders are to be submitted	:	<b>Technical Bid :</b> State Bank of India Regional Business office -3 , AO-6 1 <sup>st</sup> floor, Navyug Market GHAZIABAD -201001 <b>Price Bid: Price Bid to be uploaded Online to arrive at Indicative Price Bid</b> <a href="http://www.tenderwizard.com/SBIETENDER">www.tenderwizard.com/SBIETENDER</a>
7	Date and time of opening Tenders	:	<b><u>04<sup>th</sup> NOVEMBER 2024 04.30 pm</u></b> <b>Technical Bid : In Hard Copy</b> <b>Price Bid: Online only followed by Reverse auction</b>
8	Place of opening tenders	:	<b>Technical Bid: to be submitted in Hard Copy at</b> State Bank of India Regional Business office -3 , AO-6 1 <sup>st</sup> floor, Navyug Market GHAZIABAD -201001 <b>Price Bid: to be submitted online</b> <a href="http://www.tenderwizard.com/SBIETENDER">www.tenderwizard.com/SBIETENDER</a>
9	Defects Liability Period	:	12 months from the date of handing over of the project to the satisfaction of Bank
10	Validity of offer	:	90 days from the date of opening the tenders.
11	Liquidated Damages	:	At the rate of 0.5% of the contract value per week which subject to a maximum of 5% of the accepted contract value.
12	Note:	:	If the vendor is found to have delayed the running/in hand project beyond the prescribed time limit specified in related tender document, the vendor will not be issued the new tender until completion of the previous delayed work.

**Mode of Submission of Tender:** The tender shall be submitted in both physical and online in two cover system in accordance with the procedure detailed herein below. Scan copy of EMD to be uploaded uploaded online as Technical Bid. Specified documents shall be sealed in envelopes of appropriate size each of which shall be sealed.

- 1) First Envelope marked **Cover 1** shall contain Earnest Money Deposit instrument as per NIT
- 2) Envelope marked **Cover 2** shall be of adequate size and shall contain envelopes marked **Covers 1 & tender document (Page 1 to 10 of this document along with Undertaking as in Annexure- I** and shall be properly sealed & signed. This envelope shall be endorsed on the outside face as under:

**“COMPOSITE INTERIOR, ELECTRICAL, & ALLIED WORK FOR SBI ACB MURADNAGAR BRANCH AT GHAZIABAD”**

The envelope marked Cover 2 containing the tender documents/ Undertaking as in Annexure- I as per instructions mentioned above shall be submitted in the office of STATE BANK OF INDIA REGIONAL BUSINESS OFFICE – 3 AO-6, 1ST FLOOR, NAVYUG MARKET, GHAZIABAD-201001., ON OR BEFORE 03.30 p.m. on 04<sup>th</sup> NOVEMBER 2024, Envelope marked Cover 1 & Cover 2 containing Earnest Money Deposit along with Covering Letter and Processing Fee of Tender Document, tender document/Undertaking as in Annexure- I will be opened first. If the Earnest Money Deposit and tender document/Undertaking as in Annexure- I is not found as prescribed, the tender shall be liable to be rejected.

Thereafter, the Price bid of the successful firms / vendors will be opened online. The L-1 quote will be considered as base price and reverse auction will be conducted there from as per standard procedure. In case the date of opening of tenders is declared as a holiday, the tenders will be opened on the next working day at the same time.

State Bank of India has the right to accept / reject any or all tenders without assigning any reasons.

In case the date of opening of tenders is declared as a holiday, the tenders will be opened on the next working day at the same time.

State Bank of India has the right to accept / reject any or all tenders without assigning any reasons.

For E-Tender related queries: **Service provider:** M/s Antares Systems Limited, Registered Office at: - #24, Sudha Complex, 3rd Stage, 4th Block, Bangalore – 560079. Ph: - 080-49352000 / 40482000 Fax: - 080-49352034

**Help Desk:** Contact Person: Mr. Pravesh Mani / Mr. Tousik Ghosh / Mr. Kushal Bose Mobile no. 09044314492/ 09674758724/ 07686913157 (On working days-9 hours–18 hours) E-mail: [praveshmani.t@antaressystems.com](mailto:praveshmani.t@antaressystems.com) / [tousik.g@antaressystems.com](mailto:tousik.g@antaressystems.com) / [kushal.b@antaressystems.com](mailto:kushal.b@antaressystems.com)

For any other queries the vendors may contact the Architect MOHAN AND ASSOCIATES., New Delhi Phone No. 7290056346

**STATE BANK OF INDIA**

**SIGNATURE OF THE TENDERER**

## INSTRUCTIONS TO THE TENDERERS

### 1.0 Scope of Work

State Bank of India invites online Tenders from the Bank's Empanelled Contractors Delhi circle category(Composite)**Rs.25lacs toRs.50Lacs** for for the **Composite Interior, Electrical, & Allied Work for SBI ACB MURADNAGAR BRANCHat GHAZIABAD.**

#### 1.1 Site and its Location

The proposed work is to be carried out atComposite Interior, Electrical, & Allied Work for SBI ACB MURADNAGAR BRANCHat Ghaziabad.

### Tender Documents

2.1 The work has to be carried out strictly according to the conditions stipulated in the tender consisting of the following documents and the most workmen like manner:

Instructions to Tenderers

General Conditions of Contract

Special Conditions of Contract

Additional Specifications

Drawings

Price Bid

2.2 The above documents shall be taken as complementary and mutually explanatory of one another but in case of ambiguities or discrepancies, shall take precedence in the order given below:

- a) Price Bid
- b) Additional Specifications
- c) Technical Specifications
- d) Drawings
- e) Special Conditions of Contract
- f) General Condition of Contract
- g) Instruction to Tenderers

2.3 Complete set of tender documents including relative drawings can be downloaded from e-tendering portal of the e-tendering service provider engaged by SBI

2.4 The tender documents are not transferable.

### 3.0 Site Visit

3.1 The tenderer must obtain himself on his own responsibility and his own expenses all information and data which may be required for the purpose of filling this tender document and enter into a contract for the satisfactory performance of the work. The tenderer is requested satisfy himself regarding the availability of water, power, transport and communication facilities, the character quality and quantity of the materials, labour, the law and order situation, climatic conditions,**liaison requirements with local authorities/ authorities maintaining the campus, security agencies guarding the campus, traffic regulations in and around the site etc.;**

*The tenderer will be fully responsible for considering the financial effect of any or all the factors while submitting his tender.*

### 4.0 Earnest Money

4.1 The tenderers are requested to submit the Earnest Money of **as per NIT** in the form of Demand Draft or Bankers' Cheque in favour of **State Bank of India payable at New Delhi** drawn on any Bank in India.

- 4.2 EMD in any other form other than as specified above will not be accepted. Tender not accompanied by the EMD in accordance with clause 4.1 above shall be rejected.
- 4.3 No interest will be paid on the EMD.
- 4.4 EMD of unsuccessful tenderers will be refunded/ returned within 30 days of award of Contract.
- 4.5 EMD of successful tenderer will be retained as a part of security deposit.

#### 5.0 Initial Security Deposit

The successful tenderer will have to submit a sum equivalent to **2% of contract value less EMD**, by means of Demand Draft drawn in favour of State Bank of India payable at Dehradun within a period of 7 days of acceptance of tender.

#### 6.0 Security Deposit

- 6.1 Total security deposit shall be **5% of contract value**. Out of this 2% of contract value is in the form of initial security deposit, which includes the EMD. Balance 3% shall be deducted from the running account bill of the work at the rate of 10% of the respective running account bills i.e., deduction from each running bill account will be 10% till total 3% of contract value is reached. 50% of the total security shall be paid to the contractors on the basis of architect's certifying the virtual completion. The balance 50% would be paid to the contractors after the defects liability period as specified in the contract provided he has carried out all the work and attended to all the defects in accordance with the condition of the contract and clearance, if any, of the observations of the CTE of CVC.
- 6.2 No interest shall be paid to the amount retained by the Bank as Security Deposit.

#### 7.0 Signing of Contract Documents

The successful tenderer shall be bound to implement the contract by signing an agreement and conditions of contract attached herewith within 7 days from the receipt of intimation of acceptance of his tender by the Bank. However, the written acceptance of the tender by the Bank will constitute a binding agreement between the Bank and successful tenderer whether such formal agreement is subsequently entered into or not.

#### 8.0 Completion Period

Time is essence of the contract. The work should be completed in all respects in accordance with the terms of contract within a period of **30 days** from the date of handing over of the site.

#### 9.0 Validity of Tender

Tenders shall remain valid and open for acceptance for a period of ninety days from the date of opening price bid. If the tenderer withdraws his/her offer during the validity period or makes modifications in his/her original offer which are not acceptable to the Bank without prejudice to any other right or remedy the Bank shall be at liberty to forfeit the EMD.

#### 10.0 Liquidated Damages

The liquidated damages shall be 0.5% per week subject to a maximum of 5% of the accepted Contract Value.

#### 11.0 Rate and Prices:

- 11.1 The tenderers shall quote their rates for individual items both in words and figures. In case of discrepancy between the rate quoted in words and figures the unit rate quoted in words will prevail. If no rate is quoted for a particular item the contractor shall not be paid for that item when it is executed.
- The amount of each item shall be calculated and the requisite total is given. In case of discrepancy between the unit rate and the total amount calculated from multiplication of unit rate and the quantity the unit rate quoted will govern and the total amount will be corrected.
- 11.2.1 The tenderers need not quote their rates for which no quantities have been given. In case the tenderers quote their rates for such items those rates will be ignored and will not be considered during execution.
- 11.2.2 The tenderers should not change the units as specified in the tender. If any unit is changed the

tenders would be evaluated as per the original unit and the contractor would be paid accordingly.

- 11.3 The tenderer should not change or modify or delete the description of the item. If any discrepancy is observed he should immediately bring to the knowledge of the Architect/Bank.
- 11.4 Each page of the BOQ shall be signed by the authorized person and cutting or over writing shall be duly attested by him.
- 11.5 Each page shall be totaled and the grand total shall be given.
- 11.5.1 The rate quoted shall be firm and shall include all costs, allowances, taxes, levies etc. and deduction at source for Income Tax, Work Contract Tax etc. will be made as per statutory rules.
- 11.5.2 The contractor shall be required to conduct necessary tests of the water brought from tube well or any other outside source, from approved laboratory.
- 11.5.3 The contractor is required to comply with all act of the Government relating to labour and the rules and regulations made there under from time to time and to submit at the proper times all particulars and statements required to be furnished to the appropriate authorities.
- 12 Vendor has to submit in Hard copy the tender document along with all terms & Conditions, Specifications and subsequent annexure and corrigendum's duly signed and stamped by authorized representative/ signatory on becoming L1.**
- 12.0 Nominated Contractor for Allied work, if any.**

The contractor shall get allied works executed only through Contractors already in SBI's Panel, for different categories of works.

**Annexure-I**

**UNDERTAKING**  
**(To be submitted along with the technical Bid)**

To

THE REGION MANAGER  
STATE BANK OF INDIA  
RBO-3, AO-6  
1ST FLOOR , NAVYUG MARKET,  
GHAZIABAD -201001

Dear Sir,

**Reg.:-COMPOSITE INTERIOR, ELECTRICAL, & ALLIED WORK FOR SBI ACB  
MURADNAGAR BRANCH AT GHAZIABAD**

1. I / We refer to the tender notice issued by you for Composite Renovation Works and allied works in connection with the above.
2. **I undertake to submit in Hard copy the tender document along with all terms & Conditions, Specifications and subsequent annexure and corrigendum's duly signed and stamped by authorized representative/ signatory on becoming L1. However we accept all the terms and conditions along with the specifications, Drawings, Layouts etc defined in the tender documents.**
3. I / We hereby offer to perform, provide, execute, complete and maintain the works in conformity with the drawings, designs, conditions of contracts, specifications, schedule of quantities relating to the works.
4. I / We have satisfied myself / ourselves as to the site conditions, examined the drawings and all aspects of the tender conditions, subject to above, I / We do hereby agree, should this tender be accepted in whole or in part, to:
  - a. Abide by and fulfill all the terms and provisions of the said conditions annexed here to,
  - b. Complete the works within **30 Days** as per the work programme enclosed with the tender in two or three shifts if considered necessary by the Employer / Consultants at no extra cost to the Employer.
5. **Earnest Money of as per NIT in the form of Demand Draft / Banker's Cheque drawn in favour of State Bank of India payable at New Delhi**, respectively which, I / We note, will not bear any interest and is liable for forfeiture.
  - I. If our offer is withdrawn within the validity period of acceptance by the Employer.  
Or
  - II. If the contract agreement is not executed by us within 7 days from the date of receipt of the letter of acceptance.  
Or
  - III. If we fail to pay the initial security deposit as stipulated.  
Or
  - IV. If the work is not commenced within 3 days after issue of work order.
6. I / We understand that you are not bound to accept the lowest or any tender you receive.

The names of **DIRECTORS** of our Firm are:

1. \_\_\_\_\_
2. \_\_\_\_\_
3. \_\_\_\_\_
4. \_\_\_\_\_



Yours faithfully,

Signature .....  
Designation .....

Name of Partner / Director of the Firm, authorized to sign or name of person having power of attorney to sign the contract. (Certified true copy of power of attorney should be attached)

Signature and address of witnesses:  
.....  
.....

a. Signature .....  
Name

Address

Signature.....  
.....  
.....

b.

Name

Address

Signature.....  
.....  
.....

b.

Name

Address

.....

## AGREEMENT

This agreement made on the \_\_\_\_\_ day of \_\_\_\_\_ Two Thousand \_\_\_\_ BETWEEN **State Bank of India** a corporation constructed under the State Bank of India Act, 1955 and having its Local Head Office at New Delhi and many other places, (hereinafter called "the Employer") of the one part and M/s \_\_\_\_\_ through its \_\_\_\_\_ having its registered office at \_\_\_\_\_ (hereinafter called "the Contractor") of the other part.

WHEREAS the Employer is desirous of executing Certain Works to be **carried out at State Bank of India ACB MURADNAGAR , GHAZIABAD**, as per Schedule-I, to this agreement and has caused Drawings, Bills of Quantities and Specification describing the work to be done, prepared by SBI, New Delhi (hereinafter called "Employer").

AND WHEREAS the said Drawings, the Bills of Quantities marked pages \_\_\_\_ to \_\_\_\_ (inclusive) and the Specifications as stated have been signed by or on behalf of the parties hereto:

AND WHEREAS the Contractor has agreed to execute the work upon the Conditions of Tender and the Conditions of Contract and further subject to the Special Conditions set forth in Schedule-II hereto attached (hereinafter collectively referred to as "the said Conditions") as per the said Drawings and as described in the said Specification and included in the said Bills of Quantities for the sum of Rupees \_\_\_\_\_

---

### NOW IT IS HEREBY AGREED AS FOLLOWS:

1. In consideration of the sum of Rupees \_\_\_\_\_ to be paid at the time and in the manner set forth in the said Conditions, the Contractor shall upon and subject to the said Drawings and described in the said Specification and Bills of Quantities.
2. The Employer shall pay to the Contractor the said sum of Rs. \_\_\_\_\_  
\_\_\_\_\_ or such other sum as shall become payable hereunder at the times and in the manner specified hereinafter.
3. The term "The Consultant" in the said conditions shall mean **M/s MOHAN AND ASSOCIATES.**, 201, Padma tower-II, Rjaendraplace, New Delhi or in the event of their ceasing to be Consultants for the purposes of this Contract, such other persons as shall be nominated for that purpose by the Employer, not being a person to whom the contractor shall object for reasons considered to be sufficient 89by the Employer mentioned in the said Conditions. Provided always that no persons subsequently appointed to be Consultants under this Contract shall be entitled to disregard or overrule any decision or approval or direction given or expressed by the Consultants for the time being.
4. The said Conditions, Specifications and Priced Bills of Quantities shall be read and construed as forming part of this agreement, and the parties hereto shall respectively abide by and submit themselves to the conditions and stipulations and perform the agreement on their parts respectively in such Conditions, Specifications and Priced Bills of Quantities contained.

This agreement is subject to jurisdiction of courts in Delhi only.

**THE REGIONAL BUSINESS OFFICE – 3 AO-6, STATE BANK OF INDIA 1ST FLOOR, NAVYUG MARKET, GHAZIABAD -201001.** shall exercise powers on behalf of the said Employer for the purpose of the Contract Agreement.

Whereas both the parties agree to sign the following annexure Annexed to this Agreement in token of their acceptance.

- I) Agreement
- II) General Conditions of contract.
- III) Special Condition of Contract.
- IV) Safety Codes.
- V) Specifications.
- VI) Material Testing & Their Frequency.
- VII) List of Approved Makes/ Brands
- VIII) Priced Bill of Quantities.
- IX) Drawings.

The Bank shall pay the contractor such sum as shall become payable hereunder at the times and in the manner specified in the said Conditions mentioned in the General Conditions of Contract.

Whereas the Contractor hereby undertakes and agrees to carry out and complete the works within **30 days** from the date of handing over site or five days from the date of issue of letter of acceptances, whichever is later. The Contractor agrees and has deposited the sum of Rs.1,00,000/- by way of Initial Security Deposit for due fulfillment of this Contract for the Works. It is agreed that the Security Deposit shall be deducted from each running bills and refunded to the contractor as per clause 2 of the General Conditions of the Contract Annexed herewith.

Whereas it is agreed that the earnest money amounting to **as per NIT** deposited by the Contractor in the form of Demand Draft along with the tender shall be forfeited in full in case the Contractor does not remit the Initial Security Deposit within the stipulated period of the start of the works by the stipulated date mentioned in the award letter.

Whereas Shri \_\_\_\_\_ is the accredited representative(s) of the Contractor who would be responsible for taking instructions from the Employer in relation to the Works. The Contractor agrees to pay Sales Tax or any other Tax on material or finished works like Works Contract Tax, Turnover Tax etc. including Income Tax in respect of this Contract of the Works and the Employer will not entertain any claim whatsoever in this report nor the Employer shall be responsible to pay any Tax as mentioned above. If due to non – payment of any of the aforesaid Tax or other Taxes connected with the Works, the Contractor suffers any loss or damages occurred to the Contractor and the Employer will be entitled to claim damages from the contractor for non-completion of the Work within **12 calendar months** stipulated in Para 9, above.

Whereas the Contractor hereby declares the list of all the relative working with the Employer which is annexed herewith.

OR

Whereas the Contractor declares that none of his relative is working with the Employer.

OR

Whereas the Contractor declares that he has associated himself with the agencies of the appropriate classes of person for Sanitary and Water Supply Installation etc. or any other specialized job to complete the works.

The Plans, Drawings, Specifications, Contract Documents and the Documents above mentioned shall form basis of this Contract and the decision of the **REGIONAL BUSINESS OFFICE – 3AO-6 STATE BANK OF INDIA, 1ST FLOOR , NAVYUG MARKET, GHAZIABAD-201001.** for the time being as mentioned in the Conditions of Contract in reference to all matters of dispute as to material, workmanship or account and as to the intended interpretation of the clauses of the Agreement or any of the document attached hereto shall be final and binding on both parties and may be made rule of the court.

The work comprises of the “**COMPOSITE INTERIOR, ELECTRICAL, & ALLIED WORK FOR SBI ACB MURADNAGAR BRANCH AT GHAZIABAD**” as mentioned above and all subsidiary

and other works connected therewith on the same site as may be ordered to be done from time to time by The RBO-1,AO1, 5<sup>th</sup>FLOOR, New Delhi- 110001 for the time being even though such works may not have been shown on the , Plans or described in the said Specifications or Schedule of Quantities of various classes of Work to be done.

The Employer through theRBO-1,AO1, 5<sup>th</sup> FLOOR, New Delhi- 110001 reserves himself the right of altering the Plans, Drawings and nature of Work of adding to or omitting any items of work or having portions of the same carried out departmentally or otherwise and such alterations or variations shall be carried out without prejudice to this Contract.

All disputes arising out of or in any way connected with this agreement shall be deemed to have arisen in Delhi and only the courts of Delhi shall have jurisdiction to determine the same.

The several parts of this Contract have been read to us and fully understood by us.

In Witness whereof the parties above named have executed these presents today and year first hereinabove written.

Signed, Sealed and Delivered by:

**Authorized Representative of Employer Authorized Representative of Contractor**

**SCHEDULE I**

**COMPOSITE INTERIOR, ELECTRICAL, ALLIED WORK FOR SBI ACB MURADNAGAR BRANCH AT GHAZIABAD**”all as described in Tender and Drawings inclusive hereto as Specifications.

**SCHEDULE II**

The following Letters/ Correspondence form a part of Agreement:

- 1.
- 2.
- 3.

As witness our hands the day and year first written above,

In presence of

Signature:

Name:

Occupation:

Address:

Signature by the said Employer

Name:

Designation:

Address:

In presence of

Signature:

Name:

Occupation:

Address:

Signature by the said Contractor

Name:

Designation:

Address:

## GENERAL CONDITIONS OF CONTRACT (GCC)

### I) Definitions:

“Contract means the documents forming the tender and the acceptance thereof and the formal agreement executed between **State Bank of India (client)** and the contractor, together with the documents referred therein including these conditions, the specifications, designs, drawings and instructions issued from time to time by the architects / Bank and all these documents taken together shall be deemed to form one contract and shall be complementary to one another.

1.1 In the contract the following expressions shall, unless the context otherwise requires, have the meaning hereby respectively assigned to them.

1.1.1 ‘SBI’ shall mean State Bank of India (client) having its Corporate Centre at State Bank Bhavan, Madame Cama Road, Mumbai-400 021 and includes the client’s representatives, successors and assigns.

Consultants/ Consultants’ shall mean **SBI, New Delhi**, Site Engineer’ shall mean an Engineer appointed by the Bank as their representative to give instructions to the contractors.

5.2.1 ‘The Contractor’ shall mean the individual or firm or company whether incorporated or not, undertaking the works and shall include legal personal representative of such individual or the composing the firm or company and the permitted assignees of such individual or firms of company.

The expression ‘works’ or ‘work’ shall mean the permanent or temporary work described in the “Scope of work” and / or to be executed in accordance with the contract and includes materials, apparatus, equipment, temporary supports, fittings and things of all kinds to be provided, the obligations of the contractor hereunder and work to be done by the contractor under the contract.

5.2.2 ‘Engineer’ shall mean the representative of the Architect/Consultant.

5.2.3 ‘Drawings’ shall mean the drawings prepared by the Architects and issued by the Engineer and referred to in the specifications and any modifications of such drawings as may be issued by the Engineer from time to time. ‘Contract Value’ shall mean the value of the entire work as stipulated in the letter of acceptance of tender subject to such additions thereto or deductions there from as may be under the deductions there from as may be made under the provision herein after contained.

5.2.4 ‘Specifications’ shall mean the specifications referred to in the tender and any modifications thereof as may time to time be furnished or approved by the architect / consultant “Month” means calendar month.

5.2.5 “Week” means seven consecutive days.

5.2.6 “Day” means a calendar day beginning and ending at 00 Hrs. and 24 Hrs. respectively.

### II) Total Security Deposit

Total Security Deposit comprise of:

Earnest Money Deposit

Initial Security Deposit

Retention Money

#### 1.0 Earnest Money Deposit:

The tenderer shall furnish EMD of **Rs. as per NIT** in the form of **Demand Draft drawn in favour of State Bank of India payable at New Delhi** on any Scheduled Bank. No tender shall be considered unless the EMD is so deposited in the required form. No interest shall be paid on this EMD. The EMD of the unsuccessful tenderer shall be refunded after the decision to award the contract is taken without interest. The EMD shall stand absolutely forfeited if the tenderer revokes his tender at any time the period when he is required to keep his tender open acceptance by the SBI or after it is accepted by the SBI the contractor fails to enter into a

formal agreement or fails to pay the initial security deposit as stipulated or fails to commence the work within the stipulated time.

## 2.0 Initial Security Deposit (ISD)

The amount of ISD shall be **2% of accepted value of tender** including the EMD in the form of D/D drawn on any scheduled Bank and shall be deposited within 7 days from the date of acceptance of tender.

## 3.0 Retention Money:

Besides the ISD as deposited by the contractor in the above said manner the retention money shall be deducted from the running account bill at the rate of 10% of the gross value of work done by the contractor and claimed in each bill provided the total security deposit, i.e. **the ISD plus Retention Money shall both together not exceed 5% of the contract value.** 50% of the total security deposit shall be refunded to the contractor without any interest on issue of Virtual Completion certificate by the Architect / consultant. The balance 50% of the total security deposit shall be refunded to the contractors without interest within fifteen days after the end of defects liability period provided the contractor has satisfactorily attended to all defects in accordance with the conditions of contract including site clearance.

## 4.0 Language

The language in which the contract documents shall be drawn shall be in English.

## 3.0 Errors, Omissions and Discrepancies

In case of errors, omissions and / or disagreement between written and scaled dimensions on the drawings or between the drawings and specifications etc., the following order shall apply.

- i) Between scaled and written dimension (or description) on a drawing, the latter shall be adopted.
  - 1 Between the written or shown description or dimensions in the drawings and the correspondence one in the specification the former shall be taken as correct.
  - 2 Between written description of the item in the specifications and descriptions in bills of quantities of the same item, the former shall be adopted.
- a) In case of difference between rates written in figures and words, the rate in words shall prevail.
- b) Between the duplicate / subsequent copies of the tender, the original tender shall be taken as correct.

## 4.0 Scope of Work:

The contractor shall carryout complete and maintain the said work in every respect in strictly accordance with this contract and with the directions of and to the satisfaction of the Bank to be communicated through the architect/ consultant. The architect/ consultant at the directions of the Bank from time to time issue further drawings and / or written instructions, details directions and explanations which are hereafter collectively referred to as Architect's/ Consultant's instructions in regard to the variation or modification of the design, quality or quantity of work or the addition or omission or substitution of any work. Any discrepancy in the drawings or between the BOQ and/ or specifications. The removal from the site of any material brought thereon by the contractor and any substitution of any other materials therefore the removal and / or re-execution of any work executed by him. The dismissal from the work of any person employed / engaged thereupon.

## 6.0 i) Letter of Acceptance:

Within the validity period of the tender the Bank shall issue a letter of acceptance either directly or through the architect by registered post or otherwise depositing at the address of the contractor as given in the tender to enter into a Contract for the execution of the work as per the terms of the tender. The letter of acceptance shall constitute a binding contract between the SBI and the contractor.

## ii) Contract Agreement:

On receipt of intimation of the acceptance of tender from the SBI/ Architect the successful tenderer shall be bound to implement the contract and within **seven days** thereof he shall sign an agreement in a non-judicial stamp paper of appropriate value.

## ii) Ownership of Drawings:

All drawings, specifications and copies thereof furnished by the SBI through its architects / consultants are the properties of the SBI. They are not to be used on other work.

**iii) Detailed Drawings and Instructions:**

The SBI through its architects/ consultants shall furnish with reasonable promptness additional instructions by means of drawings or otherwise necessary for the proper execution of work. All such drawings and instructions shall be consistent with the contract documents, true developments thereof and reasonably inferable there from.

The work shall be executed in conformity therewith and the contractor prepare a detailed programmer schedule indicating therein the date of start and completion of various activities on receipt of the wok order and submit the same to the SBI through the architect / consultant.

**iv) Copies of Agreement**

Two copies of agreement duly signed by both the parties with the drawings shall be handed over to the contractors.

**v) Liquidated Damages:**

If the contractor fails to maintain the required progress in terms of clause 30 of GCC or to complete the work and clear the site including vacating their office on or before the contracted or extended date or completion without justification in support of the cause of delay, he may be called upon without prejudice to any other right of remedy available under the law to the SBI on account of such breach to pay a liquidated damages at the rate of 0.5% of the contract value per week which is subject to a maximum of 5% of the contract value.

**vi) Materials, Appliances and Employees**

Unless or otherwise specified the contractor shall provide and pay for all materials, labour, water, power, tools, equipment transportation and any other facilities that are required for the satisfactory execution and completion of the work. Unless or otherwise specified all materials shall be new and both workmanship and materials shall be of best quality. The contractor shall at all times enforce strict discipline and good order among his employees and shall not employ on the work any unfit person or anyone not skilled in the work assigned to him. Workman whose work or behavior is found to be unsatisfactory by the SBI / Architect/ Consultant he shall be removed from the site immediately.

**vii) Permits, Laws and Regulations:**

Permits and licenses required for the execution of the work shall be obtained by the contractor at his own expenses. The contractor shall give notices and comply with regulations, laws, and ordinances rules, applicable to the contract. If the contractor observes any discrepancy between the drawings and specifications, he shall promptly notify the SBI in writing under intimation of the Architect/ Consultant. If the contractor performs any act which is against the law, rules and regulations he shall meet all the costs arising there from and shall indemnify the SBI any legal actions arising there from.

**12.0 Setting out Work:**

The contractor shall set out the work and shall be responsible for the true and perfect setting out of the same and for the correctness of the positions, levels, dimensions, and alignment of all parts thereof and get it approved by the architect/ consultant before proceeding with the work. If at any time any error in this respect shall appear during the progress of the works, irrespective of the fact that the layout had been approved by the architect/ consultant the contractor shall be responsible for the same and shall at his own expenses rectify such error, if so, required to satisfaction of the SBI.

**13.0 Protection of Works and Property:**

The contractor shall continuously maintain adequate protection of all his work from damage and shall protect the SBI's properties from injury or loss arising in connection with contract. He shall make good any such damage, injury, loss, except due to causes beyond his control and due to his fault or negligence.

He shall take adequate care and steps for protection of the adjacent properties. The contractor shall take all precautions for safety and protections of his employees on the works and shall comply with all applicable provisions of Govt. and local bodies safety laws and building codes



to prevent accidents, or injuries to persons or property on, about or adjacent to his place of work. The contractor shall take insurance covers as per clause 26.0 at his own cost. The policy may take in joint names of the contractor and the SBI and the original policy may be lodged with the SBI.

**a) Inspection of Work:**

The SBI Architect/ Consultant or their representatives shall at all reasonable times have free access to the work site and/ or to the workshop, factories, or other places where materials are lying or from where they are obtained and the contractor shall give every facility to the SBI, Architect / consultant and their representatives necessary for inspection and examination and test of the materials and workmanship. No person unless authorized by the SBI/ Architect / Consultant except the representative of Public authorities shall be allowed on the work at any time. The proposed work either during its construction stage or its completion can also be inspected by the Chief Technical Examiner's organization a wing of Central Vigilance Commission.

**b) Assignment and Subletting**

The whole of work included in the contract shall be executed the contractor and he shall not directly entrust and engage or indirectly transfer, assign or underlet the contract or any part or share thereof or interest therein without the written consent of the SBI through the architect and no undertaking shall relieve the contractor from the responsibility of the contractor from active superintendence of the work during its progress.

**16.0 Quality of Materials, Workmanship & Test**

All materials and workmanship shall be best of the respective kinds described in the contract and in accordance with Architect/ Consultant instructions and shall be subject from time to time to such tests as the architect/ consultant may direct at the place of manufacture or fabrication or on the site or an approved testing laboratory. The contractor shall provide such assistance, instruments, machinery, labour, and materials as are normally required or examining measuring sampling and testing any material or part of work before incorporation in the work before incorporation in the work or testing as may be selected and required by the Architect / Consultant.

**6.0 Samples**

All samples of adequate numbers, size, shades and pattern as per specifications shall be supplied by the contractor without any extra charges. If certain items proposed to be used are of such nature that samples cannot be presented or prepared at the site detailed literature/ test certificate of the same shall be provided to the satisfaction of the Architect/ Consultant. Before submitting the sample / literature the contractor shall satisfy himself that the material/ equipment for which he is submitting the sample/ literature meet with the requirement of tender specification. Only when the samples are approved in writing by the architect / consultant the contractor shall proceed with the procurement and installation of the particular material / equipment. The approved samples shall be signed by the Architect / Consultant for identification and shall be kept on record at site office until the completion of the work for inspection / comparison at any time. The Architect / Consultant shall take reasonable time to approve the sample. Any delay that might occur in approving the samples for reasons of its not meeting the specifications or other discrepancies inadequacy in furnishing samples of best qualities from various manufacturers and such other aspects causing delay on the approval of the materials / equipment etc. shall be to the account of the contractor.

**iii) Cost of Tests**

The cost / expenditure required for the tests shall be borne by the contractor if such test is intended by or provided for in the specification or BOQ.

**iv) Costs of Tests not provided for**

If any test is ordered by the Architect / Consultant which is either

If so intended by or provided for or (in the cases above mentioned) is not so particularized, or though so intended or provided for but ordered by the Architect / Consultant to be carried out by an independent person at any place other than the site or the place of manufacture or

fabrication of the materials tested or any Government / approved laboratory, then the cost of such test shall be borne by the contractor.

#### **17.0 Obtaining Information Related to Execution of Work**

No claim by the contractor for additional payment shall be entertained which is consequent upon failure on his part to obtain correct information as to any matter affecting the execution of the work nor any misunderstanding or the obtaining incorrect information or the failure to obtain correct information relieve him from any risks or from the entire responsibility for the fulfillment of contract.

#### **18.0 Contractor's Superintendence**

The contractor shall give necessary personal superintendence during the execution of the works and as long, thereafter, as the Architect / consultant may consider necessary until the expiry of the defects liability period stated hereto.

#### **14.0 Quantities**

- ii) The Bill of Quantities (BOQ) unless or otherwise stated shall be deemed to have been prepared in accordance with the Indian Standard Method of Measurements and quantities. The rate quoted shall remain valid for variation of quantity against individual item to any extent subject to maximum variation of the contract value by 25%. The entire amount paid under Clause 20, 21 hereof as well as amounts of prime cost and provisional sums, if any, shall be excluded.

**Variation exceeding 25%:** The items of work executed in relation to variation exceeding 25% shall be paid on the basis of provisions of clause 22 (e) hereof.

#### **20.0 Works to be measured**

The Architect / Consultant may from time to time intimate to the contractor that he required the work to be measured and the contractor shall forthwith attend or send a qualified representative to assist the Architect in taking such measurements and calculations and to furnish all particulars or to give all assistance required by any of them. Such measurements shall be taken in accordance with the Mode of measurements detailed in the specifications. The representative of the Architect / Consultant shall take joint measurements with the contractor's representative and the measurements shall be entered in the measurement book. The contractor or his authorized representative shall sign all the pages of the measurement book in which the measurements have been recorded in token of his acceptance. All the corrections shall be duly attested by both representatives. No over writings shall be made in the M book should the contractor not attend or neglect or omit to depute his representative to take measurements then the measurements recorded by the representative of the Architect / consultant shall be final. All authorized extra work, omissions and all variations made shall be included in such measurement.

#### **21.0 Variations**

No alteration, omission or variation ordered in writing by the Architect / consultant shall vitiate the contract. In case the SBI / Architect / Consultant thinks proper at any time during the progress of works to make any alteration in, or additions to or omissions from the works or any alteration in the kind or quality of the materials to be used therein, the Architect / Consultant shall give notice thereof in writing to the contractor or shall confirm in writing within seven days of giving such oral instructions the contractor shall alter to, add to, or omit from as the case may be in accordance with such notice, but the contractor shall not do any work extra to or make any alterations or additions to or omissions from the works or any deviation from any of the provisions of the contract, stipulations, specifications or contract drawings without previous consent in writing of the Architect / Consultant and the value of such extras, alterations, additions or omissions shall in all cases be determined by the Architect / Consultant and the same shall be added to or deducted from the contract value, as the case may be.

#### **a) Valuation of Variations**

No claim for an extra shall be allowed unless it shall have been executed under the authority of the Architect / Consultant with the concurrence of the SBI as herein mentioned. Any such extra is herein referred to as authorized extra and shall be made in accordance with the following provisions.

- a) i) The net rates or prices in the contract shall determine the valuation of the extra work where such extra work is of similar character and executed under similar conditions as the work priced herein.

19.0 Rates for all items, wherever possible should be derived out of the rates given in the priced BOQ.

- b) The net prices of the original tender shall determine the value of the items omitted, provided if omissions do not vary the conditions under which any remaining items of works are carried out, otherwise the prices for the same shall be valued under sub-clause (c) hereunder.
- c) Where the extra works are not of similar character and /or executed under similar conditions as aforesaid or where the omissions vary the conditions under which any remaining items or works are carried out, then the contractor shall within 7 days of the receipt of the letter of acceptance inform the Architect / consultant of the rate which he intends to charge for such items of work, duly supported by analysis of the rate or rates claimed and the Architect / Consultant shall fix such rate or prices as in the circumstances in his opinion reasonable and proper, based on the market, rate.
- d) Where extra work cannot be properly measured or valued the contractor shall be allowed day work prices at the net rates stated in the tender of the BOQ or, if not, so stated then in accordance with the local day work rates and wages for the district; provided that in either case, vouchers specifying the daily time (and if required by the Architect / Consultant) the workman's name and materials employed be delivered for verifications to the Architect / consultant at or before the end of the week following that in which the work has been executed.
- e) It is further clarified that for all such authorized extra items where rates cannot be derived from the tender, the Contractor shall submit rates duly supported by rate analysis worked on the market rate basis" for material, labour, hire / running charges of equipment and wastage etc. plus 15% towards establishment charges, contractor's overheads and profit. Such items shall not be eligible for escalation.

**b) Final Measurement**

The final measurement, valuation and payment in respect of the contract shall be completed within six months of the virtual completion of the work.

**c) Virtual Completion Certificate (VCC)**

On successful completion of entire works covered by the contract to the full satisfaction of the Architects / SBI, the contractor shall ensure that the following works have been completed to the satisfaction of the Architects / SBI.

- i) Clear the site of all scaffolding, wiring, pipes, surplus materials, contractor's labour, equipment and machinery.
- ii) Demolish, dismantle and remove the contractor's site office, temporary works, structures including labour sheds/camps and constructions and other items and things whatsoever brought upon or erected at the site or any land allotted to the contractor by the SBI and not incorporated in the permanent works.
- iii) Remove all rubbish, debris etc. from the site and the land allotted to the contractor by the SBI and shall clear, level and dress, compact the site as required by the SBI.
- iv) Shall put the SBI in undisputed custody and possession of the site and all land allotted by the SBI.
- v) Shall hand over the work in a peaceful manner to the SBI.
- vi) All defects / imperfections have been attended and rectified as pointed out by the SBI to the full satisfaction of SBI.

Upon the satisfactory fulfillment by the contractor as stated above, the contractor shall be entitled to apply to the Architect / consultant is satisfied of the completion of the work. Relative to which the completion certificate has been sought, the Architect / consultant shall within fourteen (14) days of the receipt of the application for virtual completion certificate, issue a VCC in respect of the work for which the VCC has been applied.

This issuance of a VCC shall be without prejudice to the SBI's rights and contractor's liabilities under the contract including the contractor's liability for defects liability period nor shall the issuance of VCC in respect of the works or work at any site be construed as a waiver of any

right or claim of the SBI against the contractor in respect of works or work at the site and in respect of which the VCC has been issued.

d) **Work by other Agencies**

The SBI / Architect / Consultant reserves the rights to use premises and any portion of the site for execution of any work not included in the scope of this contract which it may desire to have carried out by other persons simultaneously and the contractor shall not only allow but also extend reasonable facilities for the execution of such work, the contractor, however, shall not be required to provide any plant or material for the execution of such work except by special arrangement with the SBI. Such work shall be carried out in such manner as not to impede the progress of the works included in the contract.

e) **Insurance of Works**

26.1 Without limiting his obligations and responsibilities under the contract, the contractor shall insure in the joint names of the SBI and the contractor against all loss of damages from whatever cause arising other than the excepted risks, for which he is responsible under the terms of contract and in such a manner that the SBI and contractor are covered for the period stipulated in clause 28 of GCC and are also covered during the period of maintenance for loss or damage arising from a cause, occurring prior to the period of maintenance for loss or damage arising from a cause, occurring prior to the commencement of the period of maintenance and for any loss or damage occasioned by the contractor in the course of any operations carried out by him for the purpose of complying with his obligations under clause.

- a) The works for the time being executed to the estimated current Contract value thereof, or such additional sum as may be specified together with the materials for incorporation in the works at their replacement value.
- b) The constructional plant and other things brought on to the site by the contractor to the replacement value of such constructional plant and other things.
- c) Such insurance shall be effected with an insurer and in terms approved by the SBI which approval shall not be unreasonably withheld and the contractor shall whenever required produce to the Architect / consultant the policy if insurance and the receipts for payment of the current premiums.

26.2 **Damage to Persons and Property**

The contractor shall, except if and so far as the contract provides otherwise indemnify the SBI against all losses and claims in respect of injuries or damages to any person or material or physical damage to any property whatsoever which may arise out of or in consequence of the execution and maintenance of he works and against all claims proceedings, damages, costs, charges and expenses whatsoever in respect of or in relation thereto except any compensation of damages for or with respect to:

- 22.0 The permanent use or occupation of land by or any part thereof.
- 23.0 The right of SBI to execute the works or any part thereof on, over, under, in or through any lands.
- 24.0 Injuries or damages to persons or properties which are unavoidable result of the execution or maintenance of the works in accordance with the contract.
- 25.0 Injuries or damage to persons or property resulting from any act or neglect of the SBI their agents, employees or other contractors not being employed by the contractor or for or in respect of any claims, proceedings, damages, costs, charges and expenses in respect thereof or in relation thereto or where the injury or damage was contributed to by the contractor, his servants or agents such part of the compensation as may be just and equitable having regard to the extent of the responsibility of the SBI, their employees, or agents or other employees, or agents or other contractors for the damage or injury.

26.3 **Contractor to Indemnify SBI**

The contractor shall indemnify the SBI against all claims, proceedings, damages, costs, charges and expenses in respect of the matters referred to in the matters referred to in the provision sub-clause 26.2 of this clause.

(1) **Contractor's Superintendence**

The contractor shall fully indemnify and keep indemnified the SBI against any action, claim, or proceeding relating to infringement or use of any patent or design or any alleged patent or design rights and shall pay any royalties which may be payable in respect of any article or part thereof included in the contract. In the event of any claim made under or action brought against SBI in respect of such matters as aforesaid the contractor shall be immediately notified thereof and the contractor shall be at liberty, at his own expenses to settle any dispute or to conduct any litigation that may arise there from, provided that the contractor shall not be liable to indemnify the SBI if the infringement of the patent or design or any alleged patent or design right is the direct result of an order passed by the Architect / Consultant in this behalf.

**a) Third Party Insurance**

- b) Before commencing the execution of the work the contractor but without limiting his obligations and responsibilities under clause 26.0 of GCC shall insure against his liability for any material or physical damage, loss or injury which may occur to any property including that of SBI, or to any person, including any employee of the SBI, by or arising out of the execution of the works or in the carrying out of the contract, otherwise than due to the matters referred to in the provision to clause 26.0 thereof.

**c) Minimum amount of Third Party Insurance**

Such insurance shall be effected with an insurer and in terms approved by the SBI which approval shall not be reasonably withheld and for at least the amount stated below. The contractor shall, whenever required. Produce of the Architect / consultant the policy or policies of insurance cover and receipts for payment of the current premiums.

- d) The minimum insurance cover for physical property, injury, and death is Rs. 5 lacs per occurrence with the number of occurrences limited to four. After each occurrence contractor will pay additional premium necessary to make insurance valid for four occurrences always.

**e) Accident or Injury to Workman**

The SBI shall not be liable for or in respect of any damages or compensation payable at law in respect or in consequence of any accident or injury to any workmen or other person in the employment of the contractor or any sub-contractor, save and except an accident or injury resulting from any act or default of the SBI or their agents, or employees. The contractor shall indemnify and keep indemnified SBI against all such damages and compensation, save and except as aforesaid, and against all claims, proceedings, costs, charges and expenses whatsoever in respect thereof or in relation thereto.

**f) Insurance against Accidents etc. to Workmen**

The contractor shall insure against such liability with an insurer approved by the SBI during the whole of the time that any persons are employed by him on the works and shall, when required, produce to the architect / consultant such policy of insurance and receipt for payment of the current premium. Provided always a that, in respect of any persons employed by any sub-contractor the contractor's obligation to insure as aforesaid under this sub-clause shall be satisfied if the sub-contractor shall be insured against the liability in respect of such persons in such manner that SBI in indemnified under the policy but the contractor shall require such sub-contractor to produce to the Architect / Consultant when such policy of insurance and the receipt for the payment of the current premium.

**g) Remedy on Contractor's failure to Insure:**

If the contractor fails to effect and keep in force the insurance referred to above or any other insurance which he may be required to effect under the terms of contract, then and in any such case the SBI may effect and keep in force any such insurance and pay such premium or premiums as may be necessary for that purpose and from time to time deduct the amount so paid by the SBI as aforesaid from any amount due or which may become due to the contractor, or recover the same as debt from the contractor.

Without prejudice to the others rights of the SBI against contractors. In respect of such default, the employer shall be entitled to deduct from any sums payable to the contractor the amount of any damages costs, charges, and other expenses paid by the SBI and which are payable by the contractors under this clause. The contractor shall upon settlement by the insurer of any claim made against the insurer pursuant to a policy taken under this clause, proceed with due

diligence to rebuild or repair the works destroyed or damaged. In this event all the monies received from the insurer in respect of such damage shall be paid to the contractor and the contractor shall not be entitled to any further payment in respect of the expenditure incurred for rebuilding or repairing of the materials or goods destroyed or damaged.

**f) Commencement of Works:**

The date of commencement of the work will be reckoned as the date of handing over site or three days from the date of issue of letter of acceptance of the tender by the SBI whichever is later.

**g) Time for Completion**

Time is essence of the contract and shall be strictly observed by the contractor. The entire work shall be completed within a period of **30 days** from the date of commencement. If required in the contract or as directed by the Architect / Consultant. The contractor shall complete certain portions of work before completion of the entire work. However the completion date shall be reckoned as the date by which the whole work is completed as per the terms of the contract.

**h) Extension of Time**

If, in the opinion of the Architect/consultant, the work be delayed for reasons beyond the control of the contractor, the Architect/consultant may submit a recommendation to the SBI to grant a fair and reasonable extension of time for completion of work as per the terms of contract. If the contractor needs an extension of time for the completion of work or if the completion of work is likely to be delayed for any reasons beyond the due date of completion as stipulated in the contract, the contractor shall apply to the SBI through the Architect / Consultant in writing in detail and his justification if any, for the delays. The Architect/Consultant shall submit their recommendations to the SBI in the prescribed format for granting extension of time. While granting extension of time the contractor shall be informed the period-extended time which will qualify for levy of liquidated damages. For the balance period in excess of original stipulated period and duly sanctioned extension of time by the SBI the provision of liquidated damages as stated under clause 10.0 of Instructions to the Tenderers shall become applicable. Further the contract shall remain in force even for the period beyond the due date of completion irrespective whether the extension is granted or not.

**i) Rate of Progress**

Whole of the materials, plant and labour to be provided by the contractor and the mode, manner and speed of execution and maintenance of the works are to be of a kind and conducted in a manner to the satisfaction of the Architect / Consultant should the rate of progress of the work or any part thereof be at any time be in the opinion of the Architect / consultant too slow to ensure the completion of the whole of the work by the prescribed time or extended time for completion the Architect / Consultant to expedite progress so as to complete the works by the prescribed time or extended time. Such communications from the Architect / Consultant neither shall relieve the contractor from fulfilling obligations under the contract nor will he be entitled to raise any claims arising out of such directions.

**j) Work during Nights and Holidays**

Subject to any provision to the contrary contained in the contract no permanent work shall save as herein provided be carried on during the night or on holidays without the permission in writing of the Architect / Consultant, save when the work is unavoidable or absolutely necessary for the saving of life or property or for the safety of the work in which case the contractor shall immediately advise the Architect / consultant. However the provisions of the clause shall not be applicable in the case of any work which becomes essential to carry by rotary or double shifts in order to achieve the progress and quality of the part of the works being technically required / continued with the prior approval of the Architect / Consultant at no extra cost to the SBI.

All work at night after obtaining approval from competent authorities shall be carried out without unreasonable noise and disturbance.

**k) No Compensation or Restriction of Work.**

If at any time after acceptance of the SBI shall decide to abandon or reduce the scope of work for any reason whatsoever and hence not required the whole or any part of the work to be

carried out. The Architect / Consultant shall give notice in writing to that effect to the contractor and the contractor shall act accordingly, in the matter. The contractor shall have no claim to any payment of compensation or otherwise whatsoever, on account of any profit or advantage which he might have derived from the execution of the work fully but which he did not derive in consequence of the foreclosure of the whole or part of the work.

Provided that the contractor shall be paid the charges on the cartage only of materials actually and bonafide brought to the site of the work by the contractor and rendered surplus

as a result of the abandonment, curtailment of the work or any portion thereof and then taken back by the contractor, provided however that the Architect / consultant shall have in such cases the option of taking over all or any such materials at their purchase price or a local current rate whichever is less.

“In case of such stores having been issued for SBI stores and returned by the contractor to stores, credit shall be given to him at the rates not exceeding those at which were originally issued to the contractor after taking into consideration and deduction for claims on account of any deterioration or damage while in the custody of the contractor and in this respect the decision of Architect / consultant shall be final.

#### **I) Suspension of Work**

- a) The contractor shall, on receipt of the order in writing of the Architect / consultant (whose decision shall be final and binding on the contractor) suspend the progress of works or any part thereof for such time and in such manner as Architect / consultant may consider necessary so as not to cause any damage or injury to the work already done or endanger the safety thereof for any of following reasons.
  - a) One account any default on the part of the contractor, or
  - a) for proper execution of the works or part thereof for reasons other than the default of the contractor, or for safety of the works or part thereof.
  - b) The contractor shall, during such suspension, properly protect and secure the works to the extent necessary and carry out the instructions given in that behalf by the Architect / consultant.
- ii) If the suspension is ordered for reasons (b) and (c) sub-para (i) above: the contractor shall be entitled to an extension of time equal to the period of every such suspension. No compensation whatsoever shall be paid on this account.

#### **34.0 Action when the whole Security Deposit is forfeited**

In any case in which under any clause or clauses of this contract, the Contractor shall have rendered himself liable to pay compensation amounting to the whole of his security deposit the Architect / consultant shall have the power to adopt any of the following course as they may deem best suited to the interest of the SBI.

- a) To rescind the contract (of which rescission notice in writing to the contractor by the Architect / consultant shall be conclusive evidence) and in which case the security deposit of the contractor shall be forfeited and be absolutely at the disposal of SBI.
- b) To employ labour paid by the SBI and to supply materials to carry out the work, or any part of the work, debiting the contractor with the cost of the labour and materials (the cost of such labour and materials as worked out by the Architect / Consultant shall be final and conclusive against the contractor) and crediting him with the value of the work done, in all respects in the same manner and at the same manner and at the same rates as if it had been carried out by the contractor under the terms of this contract the certificate of Architect / Consultant as to the value of work done shall be final and conclusive against the contractor.
- c) To measure up the work of the contractor, and to take such part thereof as shall be unexecuted, out of his hands, to give it to another contractor to complete in which case any expenses which may be incurred in excess of the sum which would have been paid to the original contractor, if the whole work had been executed by him (of the amount of which excess the certificates in writing of the Architects / Consultant shall be final and conclusive) shall be borne by original contractor and may be deducted from any money due to him by SBI under the contract or otherwise, or from his security deposit or the proceeds of safe thereof, or sufficient part thereof. In the event of any of above courses being adopted by the SBI the contractor shall

have no claim to compensation for any loss sustained by him by reasons of his having purchased or procured any material or entered into any engagements or make any advances on account of, or with a view to the execution of the work or the

performance of the contract and in case the contract shall be rescind under the provision aforesaid, the contractor shall not be entitled to recover or to be paid any sum or any work thereto for actually performed under this contract, unless, and until the Architect / consultant will have certified in writing the performance of such work and the value payable in respect thereof, and he shall only be entitled to be paid the value so certified.

### **35.0 Owner's Right to Terminate the Contract**

If the contractor being an individual or a firm commit any 'Act of Insolvency' or shall be adjusted an insolvent or being an incorporated company shall have an order for compulsory winding up voluntarily or subject to the supervision of Govt. and of the Official Assignee of the liquidator in such acts of insolvency or winding up shall be unable within seven days after notice to him to do so, to show to the reasonable satisfaction of the Architect / Consultant the at the is able to carry outand fulfil the contract, and to give security therefore if so required by the Architect / consultant.

Or if the contractor (whether an individual firm or incorporated Company) shall suffer execution to be issued or shall suffer any payment under this contract to be attached by or on behalf of any of the creditors of the contractor.

Or shall assign or sublet this contract without the consent in writing of the SBI through the Architect / consultant or shall charge or encumber this contract or any payment due to which may become due to the contractor thereunder:

- a) Has abandoned the contract; or
- 26 Has failed to commence the works, or has without any lawful excuse under these conditions suspended the progress of the works for days after receiving from the SBI through the Architect / Consultant written notice to proceed, or
- 27 Has failed to proceed with the works with such diligence and failed to make such due progress as would enable the works to be completed within the time agreed upon, or has failed to remove the materials from the site or to pull down and replace work within seven days after written notice from the SBI through the Architect/ Consultant that the said materials were condemned and rejected by the Architect/ Consultant under these conditions; or has neglected or failed persistently to observe and perform all or any the acts, matters or things by this contract to be observed and performed by the contractor for seven days after written notice shall have been given to the contractor to observe or perform the same or has to the detriment of good workmanship or infiance of the SBI's or Architect's/ Consultant's instructions to the contrary subject any part of the contract. Then and in any of said cases the SBI and or the Architect / Consultant, may not withstanding any previous waiver, after giving seven days' notice in writing to the contractor, determine the contract, but without thereby affecting the powers of the SBI or the Architect / Consultant or the obligation and liabilities of the contractor the whole of which shall continue in force as fully as if the contract had not been so determined and as if the works subsequently had been executed by or on behalf of the contractor. And further the SBI through the Architect / consultant their agents or employees may enter upon and take possession of the work and all plants, tools, scaffoldings, materials, sheds, machineries lying upon the premises or on the adjoining lands or roads use the same by means of their own employees or workmen in carrying on and completing the work or by engaging any other contractors or persons to complete the work and the contractor shall not in any was interrupt or do any act, matter or thing to prevent or hinder such other contractor or other persons employed for completing and finishing or using the materials and plant for the works.

When the works shall be completed or as soon thereafter as convenient the SBI or the architect / consultant shall give a notice in writing to the contractor to remove his surplus materials and plants and should the contractor fail to do so within 14 days after receipt thereof by him the SBI sell the same by public auction after due publication, and shall adjust the amount realised by such auction. The contractor shall have no right to question any of the act of the SBI incidental to the sale of the materials etc.



## 26 Certificate of Payment

The contractor shall be entitled under the certificates to be issued by the Architect / Consultant to the contractor within 14 working days from the date of certificate to the payment from SBI from time to time. The SBI shall recover the statutory recoveries towards Income tax, Work contract tax as per the prevailing bye laws and other dues including the retention amount from the certificate of payment.

Provided always that the issue of any certificate by the Architect/ Consultant during the progress of works or completion shall not have effect as certificate of satisfaction or relieve the contractor from his liability under clause.

The Architect/ Consultant shall have power to withhold the certificate if the work or any part thereof is not carried out to their satisfaction.

The Architect/ Consultant may by any certificate make any corrections required in previous certificate.

The SBI shall modify the certificate of payment as issued by the Architect/ Consultant from time to time while making the payment.

The contractor shall submit interim bills only after taking actual measurements and property recorded in the measurement books

The contractor **shall not submit interim bills** when the approximate value of work done by him is less than **50% of the total awarded amount** and maximum three bill shall be submitted.

The final bill may be submitted by contractor within a period of one month from the date of virtual completion and Architect/ Consultant shall issue the certificate of payment within a period of two months. The SBI shall pay the amount within a period of three months from the date of issue of certificate provided there is no dispute in respect of rates and quantities.

The contractor shall submit the interim bills in the prescribed format with all details.

## 37.0 Settlement of Disputes and Arbitration

Except where otherwise provided in the contract all questions and disputes relating to the meaning of the specifications, design, drawings and instructions herein before mentioned and as to the quality of workmanship or materials used on the work or as to any other question, claim, right, matter or thing whatsoever in any way arising out of or relating to the contract, designs, drawings, specifications, estimates, instructions, orders or those conditions or otherwise concerning the work or the execution or failure to execute the same whether arising during the progress of the work or after the cancellation, termination, completion or abandonment thereof shall be dealt with as mentioned hereinafter.

- b) If the contractor considers that he is entitled to any extra payment or compensation in respect of the works over and above the amounts admitted as payable by the Architect or in case the contractor wants to dispute the validity of any deductions or recoveries made or proposed to be made from the contract or raise any dispute, the contractor shall forthwith give notice in writing of his claim, or dispute to the **REGIONAL BUSINESS OFFICE – 3AO-6, STATE BANK OF INDIA 1ST FLOOR , NAVYUG MARKET, GHAZIABAD-201001**. and endorse a copy of the same to the Architect, within 30 days from the date of disallowance thereof or the date of deduction or recovery. The said notice shall give full particulars of the claim, grounds on which it is based and detailed calculations of the amount claimed and the contractor shall not be entitled to raise any claim nor shall the Bank be in any way liable in respect of any claim by the contractor unless notice of such claim shall have been given by the contractor to the **REGIONAL BUSINESS OFFICE – 3AO-6, STATE BANK OF INDIA 1ST FLOOR , NAVYUG MARKET, GHAZIABAD-201001**. in the manner and within the time as aforesaid. The contractor shall be deemed to have waived and extinguished all his rights in respect of any claim not notified to the **REGIONAL BUSINESS OFFICE – 3AO-6, STATE BANK OF INDIA 1ST FLOOR , NAVYUG MARKET, GHAZIABAD-201001**. in writing in the manner and within the time aforesaid.
- c) **THE REGIONAL BUSINESS OFFICE – 3AO-6, STATE BANK OF INDIA 1ST FLOOR , NAVYUG MARKET, GHAZIABAD-201001**. shall give his decision in writing on the claims notified by the contractor. The contractor may within 30 days of the receipt of the decision of the **REGIONAL BUSINESS OFFICE – 3AO-6, STATE BANK OF INDIA 1ST FLOOR , NAVYUG MARKET, GHAZIABAD-201001**. submit his claims to the conciliating authority

namely the **Circle Development Officer, SBI, New Delhi** for conciliation along with all details and copies of correspondence exchanged between him and the Regional Manager.

- d) If the conciliation proceedings are terminated without settlement of the disputes, the contractor shall, within a period of 30 days of termination thereof shall give a notice to the concerned **Chief General Manager of the Bank** for appointment of an arbitrator to adjudicate the notified claims failing which the claims of the contractor shall be deemed to have been considered absolutely barred and waived.
- e) Except where the decision has become final, binding and conclusive in terms of the contract, all disputes or differences arising out of the notified claims of the differences arising out of the notified claims of the contractor as aforesaid and all claims of the Bank shall be referred for adjudication through arbitration by the Sole Arbitrator appointed by the **Chief General Manager of the Bank**, It will also be the objection to any such appointment that the Arbitrator so appointed is a Bank Officer and that he had to deal with the matters to which the Contract relates in the course of his duties as Bank Officer. If the arbitrator so appointed is unable or unwilling to act or resigns his appointment or vacates his office due to any reason whatsoever another sole arbitrator shall be appointed in the manner aforesaid by the **Chief General Manager of the Bank**, Such person shall be entitled to proceed with the reference from the stage at which it was left by his predecessor.

It is a term of this contract that the party invoking arbitration shall give a list of disputes with amounts claimed in respect of each dispute alongwith the notice for appointment of arbitrator.

It is also a term of this contract that no person other than a person appointed by **Chief General Manager of the Bank**, as aforesaid should act as arbitrator.

The conciliation and arbitration shall be conducted in accordance with the provisions of the Arbitration & Conciliation Act 1996 or any statutory modification or re-enactment thereof and the rules made there under.

It is also a term of the contract that if any fees are payable to the arbitrator these shall be paid equally by both the parties. However, no fees will be payable to the arbitrator if he is a Bank Officer.

It is also a term of the contract that the arbitrator shall be deemed to have entered on the reference on the date he issues notice to both the parties calling them to submit their statement of claims and counter statement of claims. The venue of the arbitration shall be such place as may be fixed by the arbitrator in his sole discretion. The fees, if any, of the arbitrator shall, if required to be paid before the award is made and published, be paid half and half by each of the parties. The cost of the reference and of the award (including the fees, if any of the arbitrator) shall be in the discretion of the arbitrator who may direct to any by whom and in what manner, such costs or any part thereof, shall be paid and fix or settle the amount of costs to be so paid.

### 38.0 Water Supply

The contractor shall make his own arrangements for water required for the work and nothing extra will be paid for the same. This will be subject to the following conditions.

That the water used by the contractor shall be fit for construction purposes to the satisfaction of the Architect / Consultant.

The contractor shall make alternative arrangements for the supply of water if the arrangement made by the contractor for procurement of water in the opinion of the Architect/ Consultant is unsatisfactory.

The contractor shall construct temporary well / tube well in SBI land for taking water for construction purposes only after obtaining permission in writing from the SBI. The contractor has to make his own arrangement for drawing and distributing the water at his own cost. He has to make necessary arrangements. To avoid any accidents or damages caused due to construction and subsequent maintenance of the wells. He has to obtain necessary approvals from local authorities, if required, at his own cost. He shall restore the ground to its original conditions after wells are dismantled on completion of work or hand over the well to the SBI without any compensation as directed by the SBI/ Architect/ Consultant.

### 39.0 Power Supply

The contractor shall make his own arrangements for power and supply / distribution system for driving plant or machinery for the work and for lighting purpose at his own cost. The cost of running and maintenance of the plants are to include in his tender prices. He shall pay all fees and charges required for the power supply and include the same in his tendered rates and hold the owner free from all such costs. He has to obtain necessary approval from the appropriate authorities, if required.

#### **40.0 Treasure Trove etc.**

Any treasure trove, coin or object antique which may be found on the site shall be the property of SBI and shall be handed over to Bank immediately.

#### **41.0 Method of Measurement**

Unless otherwise mentioned in the schedule of quantities or in mode of measurement, the measurement will be on the net quantities or work produced in accordance with up to date. Rules laid down by the Bureau of Indian Standards. In the event any dispute / disagreement the decision of the Architect / consultant shall be final and binding on the contractor.

#### **42.0 Maintenance of Registers**

The contractor shall maintain the following registers as per the enclosed Performa at site of work and should produce the same for inspection of SBI/ Architect/ Consultant whenever desired by them. The contractor shall also maintain the records / registers as required by the local authorities / Govt. from time to time.

- i) Register for Cement / Paint / Lead / Specific Materials
- ii) Register for Steel
- iii) Register for Secured Advance
- iv) Register for Bulkage of Sand
- v) Register for Silt Test
- vi) Register for Sieve Analysis for Fine Aggregate
- vii) Register for Sieve Analysis for Course Aggregate
- viii) Register for Slump Test.
- ix) Register for Concrete Cube Test.
- x) Register for Hindrance to Work.
- xi) Register for Consumption of Cement
- xii) Register for Running Account Bill
- xiii) Register for Labour

#### **43.0 Force Majeure**

- 43.1 Neither contractor nor SBI shall be considered in default in performance of their obligations if such performance is prevented or delayed by event such as but not to war, hostilities revolution, riots, civil commotion, strikes, lockout, conflagrations, epidemics, accidents, fire, storms, floods, droughts, earthquakes or ordinances or any act of god or for any other cause beyond the reasonable control of the party affected or prevented or delayed. However a notice is required to be given within 30 days from the happening of the even with complete details, to the other party to the contract, if it is not possible to serve a notice, within the shortest possible period without delay.
- 43.2 As soon as the cause of force majeure has been removed the party whose ability to perform its obligations has been affected, shall notify the other such cessation and the actual delay incurred in such affected activity adducing necessary evidence in support thereof.
- 43.3 From the date of occurrence of a case of force majeure obligations of the party affected shall be suspended during the continuance of any inability so caused. With the cause itself and inability resulting there from having been removed, the agreed time of completion of the respective obligations under this agreement shall stand extended by a period equal to the period of delay occasioned by such events.
- 43.4.1 Should one or both parties be prevented from fulfilling the contractual obligations by a state of force majeure lasting to a period of 6 months or more the two parties shall each other to decide regarding the future execution of this Agreement?

#### **44.0 Local Laws, Acts, Regulations:**

The contractor shall strictly adhere to all prevailing labour laws inclusive of contract labour (regulation and abolition act of 1970) and other safety regulations. The contractor shall comply with the provision of all labour legislation including the latest requirements of all the Acts, laws, any other regulations that are applicable to the execution of the project.

- i) Minimum wages Act 1948 (Amended)
- ii) Payment of wages Act 1936 (Amended)
- iii) Workmen's compensation Act 1923 (Amended)
- iv) Contract labour regulation and abolition act 1970 and central rules 1971 (Amended)
- v) Apprentice act 1961 (Amended)
- vi) Industrial employed (standing order) Act 1946 (Amended)
- vii) Personal injuries (Compensation insurance) act 1963 and any other modifications
- viii) Employees' provided fund and miscellaneous provisions Act 1952 and amendment thereof.
- ix) Shop and establishment act
- x) Any other act or enactment relating thereto and rules framed there under from time to time.

#### **45.0 Accidents**

The contractor shall immediately on occurrence of any accident at or about the site or in connection with the execution of the work report such accident to the Architect / consultant. The contractor shall also such report immediately to the competent authority whenever such report is required to be lodged by the law and take appropriate actions thereof.

**Signature of Contractor & Seal**

### **SPECIAL CONDITIONS OF CONTRACT (SCC)**

**b) Scope of Work**

*The scope of work is to carry out "Composite Toilet Renovation Works for SBI BRANCH at ACB MURADNAGAR.*

**Address of Site**

*The site is located at SBI ACB MURADNAGAR, GHAZIABAD*

**c) Dimension and Levels**

*All dimensions and levels shown on the drawing shall be verified by the contractor on the site and he will be held responsible for the accuracy and maintenance of the entire dimension and the levels. Figured dimensions are in all cases to be accepted and no dimension shall be scaled. Large-scale details shall take precedence over small – scale drawing. In case of discrepancy the contractor shall ask for clarification from the Architect / Consultant before proceeding with the work.*

**d) Notice of Operation**

*The contractor shall not carry out any important operation without the consent in writing from the Architect / Consultant.*

**e) Construction Records**

*The contractor shall keep and provide to the Architect / Consultant full and accurate records of the dimension and positions of all new work and any other information necessary to prepare complete drawings recording details of the work as constructed.*

**f) Safety of adjacent Structures and Trees**

*The contractor shall provide and erect to the approval of the Architect / Consultant such supports as may be required to protect effectively all structures and protective guards to trees*

which may be endangered by the execution of the works or otherwise take such permanent measures as may be required by the Architect to protect the trees and structures.

**g) Temporary Works**

Before any temporary works are commenced, the contractor shall submit at least 7 days in advance to the architect / consultant for approval complete drawings of all temporary works he may require for the execution of the works. The contractor shall carry out the modifications relating to strength, if required by the Architect/ Consultant may require in accordance with the conditions of contract at his own cost. The contractor shall be solely responsible for the stability and safety of all temporary works an unfinished works and for the quality of the permanent works resulting from the arrangement eventually adopted for their execution.

**h) Temporary Roads**

The contractor shall provide access roads to the site from the nearest main road at no extra cost and as directed by the Architect/ Consultant. The contractor shall also responsible for proper maintenance of this access road and would take all care to see that existing services, if any, are maintained in working order at his own cost. The laying and maintaining the temporary roads within the site area shall be the contractor's responsibility and the contractor shall take such measures that are necessary and as directed by the Architect/ Consultant.

**i) Water, Power and Other Facilities**

The rate quoted by the contractor shall include all expenses that are required for providing all the water required for the work and the contractor shall make his own arrangements for the supply of good quality water suitable for the construction and good quality drinking water for their workers. If necessary, the contractor has to sink a tube well / open well and bring water by means of tankers at his own cost for the purpose. The SBI will not be liable to pay any charges in connection with the above.

The rate quoted in the tender shall include the expenses for obtaining and maintaining power connections and shall pay for the consumption charges.

The contractors for other trades directly appointed by the SBI shall be entitled to take power and water connections from the temporary water and power supply obtained by the contractor. However, the concerned contractor shall make their own arrangements to draw the supply and pay directly the actual consumption charges at mutually agreed rates between them. All municipal charges for drainage and water connection for construction purposes shall be borne by the contractor and charges payable for permanent connections, if any, shall be initially paid by the contractor and the SBI will reimburse the amount on production of receipts.

The SBI as well as the Architect / Consultant shall give all possible assistance to the contractors to obtain the requisite.

Permission from the various authorities, but the responsibility for obtaining the same in time shall be of the contractor.

**j) Office Accommodation**

b) The contractor shall provide and maintain all necessary offices, workshops, stores, shelters, sanitary facilities, canteens and other temporary structures for themselves in connection with the work at the site own cost after getting the approval from the architect / consultant.

c) All temporary buildings and facilities as mentioned above shall be removed on completion of the work or at any other earlier date as directed by the architect / consultant.

All the expenses for obtaining statutory approvals and maintenance of the above facilities as well as running expense shall be borne by the contractor at no extra cost. It is also the responsibility of the contractor to obtain statutory approvals for providing the above facilities.

**k) Facilities for Contractors' Employees**

The contractor shall make his own arrangement for the housing and welfare of his staff and workmen including adequate drinking water facilities. The contractor shall also make his arrangements at his own cost for transport where necessary for his staff and workmen to and from site of work at his own cost.

**l) Lighting of Works**

The contractor shall at all times provide adequate and approved lighting as required for the proper execution and supervision and inspection of works.

**m) Fire Fighting Arrangements**

36.0 The contractor shall at all times provide suitable arrangements for the fighting at his own cost. For this purpose he shall provide requisite number of fire extinguishers and adequate number of buckets, some of which are to be always kept filled with sand and some with water. These equipment shall be provided at suitable prominent and easily accessible places and shall be properly maintained.

37.0 Any deficiency in the fire safety or unsafe conditions shall be corrected by the contractor at his own cost and to the approval of the relevant authorities. The contractor shall make the following arrangements at his own cost but not limited to the following :

- i) Proper handling, storage and disposal of combustible materials and waste.
- ii) Worked operations which can create fire hazards.
- iii) Access for the fire fighting equipment's.
- iv) Types, number and location of containers for the removal of surplus materials and rubbish.
- v) Type size, number and location of fire extinguishers or other firefighting equipment.
- vi) General housekeeping.

**n) Site Order Book**

A site order book shall be maintained at site for the purpose of quick communication between the Architect/Consultant. Any communication relating to the works may be conveyed through Records in the site order book. Such a communication from one party to the other shall be deemed to have been adequately served in terms of contract. Each site order book shall have machine numbered pages in triplicate and shall be carefully maintained and preserved by the contractor and shall be made available to the Architect/ Consultant as and when demanded. Any instruction which the Architect/ Consultant may like to issue to the contractor or the contractor may like to bring to the Architect/ Consultant may like to issue to the Contractor or the Contractor may like to bring to the Architect/ Consultant two copies of such instructions shall be taken from the site order book and one copy will be handed over to the party against proper acknowledgment and the second copy will be retained for their record.

**o) Site Meetings**

Site meetings will be held to review the progress and quality evaluation. The contractors shall depute a senior representative along with the site representative staff of approved sub-contractors and suppliers as required to the site meetings and ensure all follow up actions. Any additional review meetings shall be held if required by the Architect/ Consultant.

**p) Disposal of Refuse**

The contractor shall cart away all debris, refuse etc. arising from the work from the site and deposit the same as directed by the Architect/ Consultant at his own cost. It is the responsibility of the contractor to obtain from the local authorities concerned to the effect that all rubbish arising out of contractor's activities at the construction site or any other off-site activities borrow pits has been properly disposed off.

**q) Contractor to Verify Site Measurement**

The contractor shall check and verify all site measurements whenever requested by other specialist's contractors or other sub-contractors to enable them to prepare their own shop drawings and pass on the information with sufficient promptness as will not in any way delay the works.

**r) Displaying the Name of the Work**

The contractor shall put up a name board of suitable size as directed by the Architect/ Consultant indicating there in the name of the project and other details as given by the Architect/ Consultant at his own cost remove the same on completion of work.

**s) Bar Bending Schedule**

The contractor shall prepare a detailed bar bending schedule for all reinforced concrete works and get them approved by the Architect/ Consultant well in advance.

**t) As Built Drawings**

- 1.0 For the drawing issued to the contractor by the Architect/Consultant. The Architect / Consultant will issue two sets of drawings to the contractor for the item for which some changes have been made. From the approved drawings as instructed by the SBI / Architect / Consultant. The Contractor will make the changes made on these copies and return these copies to the Architect/ Consultant for their approval. In case any revision is required or the corrections are not properly marked the Architect/ Consultant will point out the discrepancies to the contractor. The contractor will have to incorporate these corrections and /or attend to discrepancies either on the copies as directed by the Architect/ Consultant and resubmit to him for approval. The Architect / Consultant will return one copy duly approved by him.
- 2.0 For the drawings prepared by the Contractor, the Contractor will modify the drawing prepared by him wherever the changes are made by the SBI / Architect/ Consultant. And submit two copies of such modified drawings to the Architect/ Consultant for approval. The Architect/ Consultant will return one copy of the approved drawing to the Contractor.

**u) Approved Make**

The Contractor shall provide all materials from the list of approved makes at his own cost. The Architect/ Consultant may approve any make / agency within the approved list as given in the tender after inspection of the sample / mock up.

**v) Procurement of Materials**

The Contractor shall make his own arrangements to procure all the required materials for the work. All wastage's and losses in weight shall be to the contractors account.

**w) Excise Duty, Taxes, Levies etc.**

The contractors shall pay and be responsible for payment of all taxes **except GST**, duties, levies, royalties, fees cess, or charges in respect of the works including but not limited to sales tax, tax on works contract excise duty, and octroi, payable in respect of materials, equipment's plant and other things required for the contact. All of the aforesaid taxes except GST, duties, levies, fees and charges shall be to the contractors account and the SBI shall not be required to pay any additional or extra amount on this account. Variation of taxes, duty fees, levies etc if any, till completion of work shall be deemed to be included in the quoted in the quoted rates and no extra amount on this account. Variation of taxes, duties, fees, levies, etc if any till completion of work shall be deemed to be included in the quoted rates and no extra claim on this account will in any case be entertained. If a new tax or duty or levy or cess or royalty or octroi is imposed under as statue or law during the currency of contract the same shall be borne by the contractor.

**x) Acceptance of Tender**

The SBI shall have the right to reject any or all tenders without assigning any reason. They are not to bound to accept the lowest or any tender and the tenderer shall have no right to question the acts of the SBI. However, the adequate transparency would be maintained by the SBI

## **SPECIFICATIONS OF INTERIOR&FURNISHING WORKS**

**1. General:**

- 1.1 Without forgoing the requirements of the Conditions of Tender and the Conditions of Contract the works in general shall confirm to the "Latest Specifications" published by CPWD, Dehradun and the "Specifications for Works" stated in this tender. In case of items not covered by the General Specifications referred above, reference shall be made to the appropriate I.S. Code. If there is any difference in the particular specifications of individual item of work and the description of item as given in the Schedule of Quantity, the latter shall prevail. In case of any work for which there is no specification in I.S. Specifications or in the specifications forming part of tender documents or in case there is any variation, such work shall be carried out in all respects in accordance with the instructions to be issued by the Architects. The term Department shall mean the Employer. Any reference to ISI shall also mean reference to its successor Bureau of Indian Standards. All corrections to "Latest Specifications" or revisions of I. S. shall be deemed to apply to this contract.
- 1.2 Materials bearing ISI certification mark shall be given highest preference for use in the works.

- 1.3 Where the Contractor is required to do, perform, execute (etc.) any work or service or the like, it shall be deemed to be at his own cost. Absence of terms providing supplying, installing, fixing, etc. shall not even remotely entitle the Contractor to any additional payment thereof.
- 1.4 The rates accepted in the Schedule of Quantities apply to all floors, heights, depths, leads, lifts, spans, sizes, shapes, locations, etc. unless a distinction has been included in the very Schedule.
- 1.5 The Specifications and the Schedules may have been divided into various sub-heads for convenience only. This does not limit applicability of one to the other nor it absolves the Contractor of his responsibility to complete any trade/item of work as reasonably inferred from one or more of such sub-heads.
- 1.6 The Schedule of Quantities is not necessarily based on "Schedule of Rates – Delhi 2003 or any of its later/earlier versions. Hence the Schedule of Quantities shall be read and construed according to explanations given herein and intentions gathered therefrom. A mere parallel drawn from the said Schedule of Rates shall therefore not form a basis for a variation and, or additional payment.
- 1.7 All work under this contract is deemed to be performed above subsoil water level. However, removal of water collected from rains and the like shall be treated as part of contractual risk/obligation.
- 1.8 Screws, bolts, nuts, washers, hold fasts, lugs, anchors, clamps, plugs, suspenders, brackets, straps and fasteners of the like are deemed to be included in the rates of various items unless the Schedule of Quantities expressed a different intention.
- 1.9 Resetting any displacements, making good holes/chases and such other incidental jobs are included in rates of respective items for which these are required.

## **2.0 Concrete Work (Plain or Reinforced):**

- 2.1 Centering, shuttering, staging, form work, strutting, propping (their provision and removal) shall not be paid for separately unless exclusion thereof is specifically described in the item.
- 2.2 The rates of concrete work do not include rendering or plastering but hacking and preparing surface for receiving the finishes shall be done as early as possible.
- 2.3 Any chamfers, grooves, drips, etc. which are generally and customarily required shall be provided in the concrete work integrally or otherwise without extra charges as directed by the Architect.

## **3.0 Steel Work:**

- 3.1 The measurement of railing shall be the length of top wood/steel section as per situation along the centre line.
- 3.2 Painting in relation to steel work shall be two or more coats of approved synthetic enamel plus a coat or primer including preparation of surfaces, fillers etc. The priming coat shall be measured & paid separately in the relevant item.
- 3.3 Circular work, bends, stepping are not payable extra.
- 3.4 The steel work in single sections of R.S. Joists, flats, Tees Angles fixed independently with or without connecting plate, is described in these clauses.

### **(a) Fabrication**

The steel section as specified shall be straightened and cut square to correct lengths and measured with a steel tape. The cut ends exposed to view shall be finished smooth. No two pieces shall be welded or otherwise jointed to make up the required length of a member.

All straightening and shaping to form, shall be done by pressure. Bending or cutting shall be carried out in such a manner as not to impair the strength of the metal.

### **(b) Painting**

All surfaces which are to be painted, oiled or otherwise treated shall be dry and thoroughly cleaned to remove all loose rust. Surfaces not in contact but inaccessible after shop assembly, shall receive the full specified protective treatment before assembly. This does not apply to the interior of sealed hollow sections. Part to be encased in concrete shall not be painted or oiled. A priming coat of approved steel primer i.e. Red Oxide Zinc chrome primer conforming to IS: 2074 shall be applied before any member of steel structure are placed in position or taken out of workshop.

### **(c) Welding**

Welding shall generally be done by electric arc process as per IS: 816 and IS: 823. The electric arc method is usually adopted and is economical. Where electricity for public is not available generators shall be arranged by the contractor at his own cost unless otherwise specified. Gas welding shall only be resorted to using oxyacetylene flame with specific



approval of the Engineer-in-charge. Gas welding shall not be permitted for structural steel work. Gas welding requires heating of the members to be welded along with the welding rod and is likely to create temperature stresses in the welded members. Precautions shall therefore be taken to avoid distortion of the members due to these temperatures stresses.

The work shall be done as shown in the shop drawings which should clearly indicate various details of the joints to be welded, type of welds, shop and site welds as well as the types of electrodes to be used. Symbol for welding on plane and shops drawings shall be according to IS: 813.

As far as possible every efforts shall be made to limit the welding that must be done after the structure is erected so as to avoid the improper welding that is likely to be done due to heights and difficult positions on scaffolding etc. apart from the aspect of economy. The maximum dia of electrodes for welding any work shall be as per IS: 814 and appendix B' of IS: 823. Joint surfaces which are to be welded together shall be free from loose mill scale, rust, paint, grease or other foreign matter, which adversely affect the quality of weld and workmanship.

#### **4.0 Flooring:**

- 4.1 The rates of cement concrete flooring and marble chips flooring are exclusive of dividing strips for formation of panels.
- 4.2 Borders, margins, bands, nosings, etc. are not payable extra. Treads shall be measured as floors, risers as skirtings. However, areas of returns (finished thickness), nosing shall be added respective items.
- 4.3 No extra shall be paid for cutting of glazed tiles or for wastage thereof.
- 4.4 Marble/Kota stone slabs shall be of selected quality, hard & sound and shall be approved by the Architects. The thickness of the slabs shall be as specified in the description of the item. Tolerance of 2mm shall be allowed for the thickness. In respect of length & breadth of slabs (Where flooring to be laid) a tolerance of 5mm shall be allowed. Every slab shall be cut to the required size and shape, top waviness shall be removed, the sides (edges) shall be removed, the sides (edges) shall be table rubbed with coarse sand or machine rubbed before paving. All angles of the tiles shall be true equal and free from chipping and the surface shall be true and plane.
- 4.5 Marble slab/kota slab shall be cleaned, wetted and mopped before laying.
- 4.6 Polishing shall be done by machine in four different courses. Ist course shall be of rubbing with carborundum stone No. 60, the second with No. 120, and the third with No. 320 to get even and smooth surface without pinholes. Where ever use of machine is not feasible to work, polishing shall be done by hand with No. 60, No. 80 and with No. 120 carborundum stone respectively. Lastly oxalic acid shall be dusted over the surface @ 33 gm per square meter sprinkled with water and rubbed hard with namdah block (pad of wooden rags).
- 4.7 Marble chips, kota stone, marble (all floors, skirting, risers, dado, counter tops, treads) shall finally be polished with approved floor wax polish as directed at no extra cost.
- 4.8 Marble (counter tops) shall be of full width and in single piece upto length of 1.5m. Granite for name-plate shall be in one single piece.

#### **5.0 Finishing:**

1. Items of plastering apply to all locations including rough sides of walls, curved surfaces, all heights, etc. without limiting generally of para 1.4.
2. Preparation of surfaces including raking out joints, hacking, brushing, watering, etc. is included.
3. Drip mouldings shall not be payable extra.
4. Grooves shall be provided in plaster as directed by Architect at corners of ceiling slabs around the columns & beams at no extra cost.
5. Strips of G.I. chicken mesh 250mm wide shall be provided in plaster at all junctions (which are flush) between masonry/columns, masonry/beams.

#### **6. Wood Work:**

- 6.1 The areas of doors & windows shutters shall be measured to the nearest cm in closed position covering the rebates of the frame but excluding the gap between the shutter and the frame. Over lap of two shutters shall not be measured. All work shall be measured for finished dimensions. No allowance shall be made for dimensions supplied beyond those specified.

Length of each piece shall be measured overall nearest to 1 cm, so as to include projections for tenons, scraves or mitres, width and thickness shall be measured to the nearest mm.

- 6.2 Where painting, polishing has been included in the item the same shall be executed as per Architect's directions. Painting shall be two or more coats of approved synthetic enamel plus a coat of fire resistant primer to wood work as approved by Architect and shall conform to BS-476 part 7 for class I surface spread of flame. Preparations of surfaces, fillars, etc. are included. This primer shall also be applied before polishing (i.e. French Spirit Polish). The fire resistant primer shall be measured & paid separately in the relevant item.

- 6.3 All flush door shutters shall have teak lipping on all edges as directed with extra thickness of lipping of meeting edges of double shutter doors.

Glasses 5.5mm thick or 4mm thick shall respectively weigh not less than 13.75 Kg/sqm. Or 10 Kg/sqm.

Bends, stepping and circular shapes in railings are integral part of the rate.

The widths of various rails & styles shall be as described in the items or shown in the drawing. All aluminum section & fittings used shall be ISI marked. All screws for fixing of fittings/fixtures shall be of matching finish.

In case of composite units (M.S. frame + teak wood shutter) the hold fasts shall be added or fixed with counter sunk machine screws. Also the M.S. frames shall have necessary holes and other arrangement for receiving/fixing of fittings

#### **7. Plaster of Paris Punning (P. O. P.)**

If the plaster surface is to be finished with plaster of paris punning, the surface shall be combed slightly with the wire brushes or nails before it is completely set to form key for plaster of Paris punning. The surface shall be thoroughly cleaned of dust then only damped but not soaked before the application of plaster of paris punning. The Gypsum for preparing punning shall be approved quality. It shall be dry and free from lumps and shall be suitably packed in watertight bags or containers. Paste shall be prepared by adding required quantum of water and it shall be used before it sets. No dropping paste shall be used in the work. Punning shall be applied to the prepared surface with steel trowel to a thickness required to make the surface produce perfectly smooth and even surface working from top to bottom. It shall then be sand papered to give a smooth and even surface. Any unevenness shall be made good by applying putty, made of plaster of paris mixed with water, then sand papering the same after it is dry. Pilling in plaster shall be made good with plaster of paris mixed with colour to be used. The surface shall then be rubbed down again with a fine grade sand paper and made smooth. The surface shall be allowed to dry thoroughly before the regular coat of paint is applied. The measurement shall be in square metre.

#### **8. Plastic Emulsion Paint:**

Plastic emulsion paint shall be of approved manufacturer and shall generally confirm to IS-5411 (Part-I)-1969.

The colour and shade of the emulsion shall be got approved by the Architect. Double scaffolding shall be used, ladden if used shall be tied with old gunny bags at top to prevent damage or scratches to the walls. The instructions of the manufacturer shall be followed, in application of priming and finishing coats. Turpentine or any other solvent shall not be used for thinning the paint.

Minimum 3 coats of paint shall be applied inclusive of primer coat. If a proper and even surface is not obtained to the satisfaction of the Architects in 3 coats, Contract shall carry out additional coats of painting to approval at his expenses. Care shall be taken that dust or other foreign material does not settle or disfigure the various coats. The measurement shall be in square metre.

#### **9. Miscellaneous:**

The work of cupboard/cabinets shall be done as per drawings. The depth of cupboards shall be as shown in drawings. The work includes holdfasts and other accessories usually required for complete installation. All inner surfaces shall be painted & outer face polished as per Architects approval.

All exposed cut ends of boards shall be provided with hardwood lippings.

Kail wood to be used shall be of the best available quality.

The joints in cement concrete pavements/roads shall be formed as per design and pattern. The joints shall be cleaned and neatly filled with 'A' grade sealing compound. Side kerbs shall be made in situ to design and volume paid for in the same item. Required side forms shall not be paid separately.

For whitewashing, colour washing, distemping on sand faced plaster or on rough cast plaster with stone aggregate upto 10mm, only flat single surface will be measured and paid.

In the case of R.C.C. Jallies upto 50mm thick only single flat surface will be considered for each side of painting.

### **SPECIFICATIONS FOR SERVICES**

#### **i) General**

- 1.1 The drawings for services are diagrammatic but shall be followed as closely as actual construction permits. Any deviations from the drawings shall be in conformity with architectural and structural drawings. The dimensions designated by the manufacturers shall take precedence over the drawings.
- 5.3 At completion of work the Contractor shall submit one set of tracings and two sets of prints of "As-Built-Drawings". These drawings shall, among others, include invert levels, pipe runs, diameters, location of valves, access panels, layout of equipment, piping connections and such other information for maintenance & future extensions. Guarantees given by manufacturers shall be assigned to the Employer along with names & addresses of manufacturers, suppliers and information about spare parts.
- 5.4 All site test shall be carried out with prior intimation to the Bank Engineer / Architect. All defects shall be rectified and tests conducted again to the satisfaction of the Bank Engineer / Architect. In addition to the test required by the specifications, the Contractor shall also conduct tests required by the Architect and by the Municipal or other Authorities.
- 5.5 All work shall be executed by competent and licensed persons. The contractor shall maintain liaison with Municipal and other controlling Authorities. He shall obtain their approvals and certificates as required by the bye – laws at appropriate stages.
- 5.6 No cutting / chasing shall be done in load bearing structural members without prior approval of the Asstt. Engineer. Sleeves and openings shall be provided during the progress of construction in preference to cutting at later date.
- 5.7 The Architect may require typical mock up(s) to be installed in advance for approval. Undamaged materials from the mock up shall be allowed to be reused in the work.
- 5.8 Unless otherwise described in the item CI / SCI pipes and fittings shall be a spigot and socket type.
- 5.9 G.I. pipe spouts shall be paid as per item of G.I. pipes (internal work). Cutting and making good is included. The free ends may be skew-cut.
- 5.10 Wherever use of G.I. pipes is called for the same shall be medium class (class – B)

#### **ii) Materials :**

- 2.1 The materials shall conform to the specifications and in absence thereof to Indian Standards. The products should bear the ISI Mark.
- 2.2 The makes of materials for use in this work are broadly approved as per list given below. The Contractor shall, however, get particular makes and samples approved before ordering:
- 2.3 Notwithstanding any interim or final approval the Contractor remains responsible for satisfactory performance of all fittings & fixtures. The liability of the Contractor is not limited by any approval of the make of materials.

- 2.4 The item rate of mirror includes extra packing piece of AC plain sheet, where required due to off set between plaster & glazed tiles surface.

**iii) Testing**

- a) The sand cast iron soil, waste and vent pipes and fittings including joints shall be tested by pumping smoke into the pipe at the lowest end.
- b) All G.I pipes and fittings including joints shall be tested to hydraulic pressure of 6 kg / cm<sup>2</sup> (60 meters) avoiding water hammer. The test pump having been stopped the test pressure should maintain without loss for at least half an hour. The pipes and fittings shall be tested in sections as the work of laying proceeds keeping the joints exposed for inspection during the testing.
- c) All stone ware pipes shall be tested with water pressure of 1.5m head of water at the highest point of the section under test.

**SPECIAL CONDITIONS OF CONTRACT FOR ELECTRICAL WORK**

**1. SCOPE OF WORK: -**

The scope of work to be carried out under this contract comprises of the supply, installation, testing and commissioning of Electrical work complete as listed out in Schedule of Quantities. The general character and scope of work to be carried out under this contract is presented in drawings and specifications. The contractor shall carry out and complete the said work under this contract in every respect in conformity with the contract documents and with direction of and to the satisfaction of the bank engineer/ Consultant/ Consultant. The contractor shall furnish labour, materials, equipment, transportation and incidentals necessary for the completion of work as described in the Tender Documents.

**2. FEES AND PERMITS: -**

The Contractor shall obtain all permits/licenses and pay for any and all fees required for the installation, inspection and the commissioning of the work.

**3. DRAWINGS: -**

**The Drawings prepared by the consultants are indicative only of the general arrangement of the installation work. The Contractor shall follow these drawings and specifications & preparing his shop drawings and subsequent installation. He shall check the drawings of other trades to verify space for his installation.**

1. Shop drawings shall be provided of the Main and Sub-Main Switchboards, Distribution Boards, Cable Trays, Reactive Power Compensation Panel, and any other switchboards and panels, wherever applicable and approval shall be obtained from the Consultant / Developer before commencing fabrication or procurement.

2. Any equipment or switchboard manufactured without the written consent of the Consultant / Developer prior to the approval drawings shall be liable for rejection.

Drawings show general run of cables, approximate locations of outlets and equipment, utility symbols and schematic diagrams of no dimensional significance. Refer to the Consultant drawings for locations and also obtain approval from the Consultant / Developer wherever dimensions are not shown, or locations cannot be determined from the drawings. Do not scale drawings to obtain locations

4. **MEASUREMENTS OF WORK:-**

Payment for Conduiting, cables, earth strips and wires etc. will be made on linear measurements and will be measured upto and including the bends.

5. **TESTING:-**

On completion of the installation the testing will be done in conformity with the stipulated performance specifications. Any shortcoming detected in the system/materials/ workmanship shall be rectified by the contractor to the entire satisfaction of the consultant without any extra cost to the owner. The installation shall be tested again after removal of the defects and shall be commissioned only after approval by the competent inspecting authority and the Consultant/Owner.

1. The Contractor shall notify the Consultant at least 7 working days before testing of each system. The Consultant reserves the right to be present when such tests are being made.
2. If the Electrical Inspectorate requires manufacturer's test reports for any equipment used in the project, the Contractor shall obtain such approvals at no extra cost to the client. Such approved reports shall be handed over to the Consultant / client.  
Calibration certificates shall be obtained from the Meter and Relay Testing Department of the Electricity Board for all relays and meters used in the project at no extra cost to the client

6. **COMPLETION CERTIFICATE: -**

On completion of the installation a certificate in an approved form shall be furnished by the contractor. The contractor shall be responsible for getting the entire installation duly approved by the Electrical Inspector or other concerned authorities, if any, and shall bear all expenses in connection with the same.

7. **SCOPE OF WORK**

The scope of work to be carried out under this contract briefly comprises of:

- a. **INTERNAL ELECTRICAL WORK:** Supply, Installation, connecting, testing and commissioning of the following:
  - i) Conduiting and wiring for all light points, exhaust fans, Light & power socket outlets, three phase outlets and equipment wiring.
  - ii) Complete earthing system
  - iii) Conduiting for Telephone system.
  - iv) Conduiting for Computer system.
  - v) All Cables, Mains & Sub-Mains
  - vi) All Final Distribution Boards.
    - All Light fixtures.
    - Fire detection system
- b) The contractor shall carry out and complete the work under this contract in every respect in confirming with the current rules and regulations of the local Electricity Authority, stipulations of the Indian Standard Institution, and with the directions of and to the satisfaction of the owner. The contractor shall furnish all labour, material, appliances, equipment, transportation and incidentals necessary for providing, installing, testing and commissioning of the whole electrical installation as specified herein and shown as drawings.

This also includes any materials, appliances, equipment and incidental work not specifically mentioned herein or noted on the drawings/documents as being furnished or installed but which are customary to make the installation in working order. The work shall include all

incidentals and jobs connected with Electrical installation such as earthing work and cutting chases/holes and making good the same and grouting and equipment.

All Civil works in connection with the Electrical Installation including supply, laying and fixing of necessary inserts, hooks, brackets and sleeves etc

On completion of the work and before issuing of virtual completion certificate the contractor shall submit to owner "As installed drawings" showing all the details of work done by him.

The contractor shall have a valid contracting license before starting the work and till the completion of work.

## **TECHNICAL SPECIFICATION**

### **1 SPECIFICATIONS FOR INTERNAL WIRING**

#### **1.1. SYSTEM OF WIRING:**

The system of wiring shall consist of single/multi core FRLS PVC insulated stranded copper conductor wires in non-metallic FRLS PVC conduits/ metallic M.S. conduits as called for in the BOQ. All conduits shall be on the surface, (supported from the Ceiling), in the False Ceiling and concealed in other areas where RCC slab is provided unless otherwise called for in the drawings. All Down conduits shall be concealed unless otherwise called for.

#### **1.2. GENERAL**

Prior to laying of conduits, the Contractor shall get approved the conduit layout indicating the route of conduit, number and size of conduits, location of junction/ inspection/pull boxes, size and location of switch boxes, point outlet boxes and other details. These conduit layouts shall be got approved by the Consultant and then only conduit layout should be started. Any modification or suggestions shall be approved by the Consultant before the laying of conduits.

#### **1.3. MATERIALS:**

M.S. conduits shall conform to Indian Standards IS: 1653 - 1964 -Specification for Rigid Steel conduits for Electrical wiring with the latest amendments.

##### **M.S. CONDUITS:**

M.S. conduits shall be solid drawn or lap welded conduits. Stove enameled inside and outside with minimum wall thickness of 1.6 mm for conduits up to 25 mm diameter and 2.0 mm wall thickness for conduits 32 mm diameter and above.

FRLS PVC conduits to be used for concealed work for all systems except Fire Alarm & Computer system where M.S. conduits shall be used. FRLS PVC conduits shall conform to Indian Standards IS: 9537(Part-3)-1983 -Specification for conduits for Electrical Installation (Part-I) General Requirements.

##### **FRLS PVC CONDUITS:**

FRLS PVC conduits shall be rigid, unplasticized, heavy gauge having 1.8 mm wall thickness up to 20 mm diameter and 2.0 mm wall thickness for all sizes above 20 mm diameter. Minimum size of conduit shall be 20 mm dia. Minimum size of conduit for Power point wiring shall be 25

mm dia. The conduits shall be delivered to the site of construction in original bundles and each length of conduit shall bear the label of the manufacturer. The number of insulated copper wires that may be drawn into the conduits of various sizes are given below and the fill shall not exceed 40% the maximum permissible number of 650/1100 volts grade single/multi core PVC insulated copper conductor wires of different sizes that may be drawn into rigid metallic or non-metallic conduits.

Nominal cross- Sectional area of wires in sq. mm	<u>SIZE OF WIRE</u>					<u>SIZE OF CONDUITS (MM)</u>
	20	25	32	40	50	nominal dia in mm
	( Maximum number of wires )					
1.5	5	6	18	-	-	
2.5	3	4	10	-	-	
4.0	2	3	5	10	-	
6.0	-	4	6	8	-	
10.0	-	-	3	4	-	
16.0	-	-	-	3	5	
25.0	-	-	-	2	3	

#### 1.4 FRLS PVC CONDUIT ACCESSORIES & CONNECTIONS:

The accessories used for FRLS PVC conduits shall conform to Indian Standards IS: 3419-1988-(Specification for fittings for non-metallic conduits).PVC conduits shall be joined by means of screwed or plain couplers. Where there are long runs of straight conduits, inspection boxes shall be provided at intervals as approved by the consultant. The threads of the pipe and sockets shall be free from grease and oil. It shall be thoroughly cleaned before making the screwed/plain joints. Proper jointing materials as recommended by manufacturers shall be used for jointing of FRLS PVC pipes. Use PVC couplers and connectors for FRLS PVC pipe connections and terminations in boxes. All the joints shall be fully watertight. Junction boxes and running joints shall be provided at suitable places to allow for subsequent extensions if any, without undue dismantling of conduit system. As far as possible diagonal run of conduits shall be avoided. Junction between conduit and adapter boxes, back outlet boxes, switch boxes and the like must be provided with entry spouts and smooth PVC bushes. Joints between conduit and iron clad Distribution Boards or control gear shall be affected by means of conduit couplers into each of which will be coupled smooth PVC bush from the inside of box or case. Conduit system shall be erect and straight as far as possible. All jointing methods shall be subject to the approval of the consultant.

#### **BENDS IN CONDUITS:**

Where necessary bends or diversions may be achieved by means of bends and or circular inspection boxes with adequate and suitable inlet and outlet screwed joints. In case of recessed system each junction box shall be provided with a cover properly secured and flush with the finished wall surface, so that the conductors inside the conduits are easily accessible. No bend shall have a radius of less than 2.5 times the outside diameter of the conduit. Conduits shall be cold bend by means of a Bending spring available with the manufacturers. In case it is not available then Heat may be used to soften the PVC conduits, by filling sand in the pipe. Use of PVC conduit in places where ambient temperature is 60 degrees or above is prohibited. PVC Solvent shall be used for joints between conduits, conduits & Junction box etc. PVC checknuts and bushes shall be used for joining conduit with outlet boxes. PVC Closures shall be provided on unused mouths of Junction boxes.

Separate conduits shall be provided for the following system.

- i) Lights, Exhaust fans & 5A Light sockets.
- ii) Power sockets
- iii) Telephone System
- iv) Television, Computer & Music system

- v) Emergency System.
- vi) Public Address System
- vii) Fire Alarm System.

Separate switchboards/outlets shall be provided for the following system.

- i) Lights, Exhaust fans & 5A Light sockets.
- ii) Power sockets & A/C outlets
- iii) Telephone System
- iv) Television, Computer & Music system
- v) Emergency System.
- vi) Public Address System
- vii) Fire Alarm system.

#### 1.5 **FIXING CONDUITS:**

Conduits and junction boxes shall be kept in position and proper holdfasts shall be provided. Conduits shall be so arranged as to facilitate easy drawing of wires through them. Adequate junction boxes of approved shape and size shall be provided. All conduits shall be installed so as to avoid steam and hot water pipes. After the conduits, junction boxes, outlet boxes & switch boxes are installed in position their outlets shall be properly plugged so that water, mortar, insects or any other foreign matter does not enter into the conduit system. Exposed conduits shall be fixed by means of spacer bar/ saddles at intervals of not more than 600 mm in normal run and 500 mm from both sides of fitting or accessories. The saddles shall be of 3 mm x 19 mm mild steel flat, properly treated with primer and painted, securely fixed to support by means of nuts and bolts/raw bolts and MS screws as required.

Conduits shall be laid in a neat and organised manner as directed and approved by the Consultant. Conduit runs shall be planned so as not to conflict with any other service pipelines/ducts.

Where exposed conduits are suspended from the structure they shall be clamped firmly and rigidly to hangers of design to be approved by the Consultant. Where hangers are to be anchored to reinforced concrete appropriate inserts and necessary devices for their fixing shall be provided at the time of fixing. Making holes or openings in the concrete will generally not be allowed. In case it is unavoidable prior permission of the Consultant shall be obtained. Conduits shall be fixed in the chase by means of staples not more than 600 mm apart and the chase filled with cement mortar 1 : 4 . Cutting of horizontal chases in walls is prohibited.

#### 1.6. **PROTECTION**

To minimize condensation or sweating inside the conduit pipes all outlets of conduit system shall be adequately ventilated as directed and approved by the Consultant. All screwed and socketed connections shall be adequately made fully watertight by the use of proper jointing materials i.e. Tropolin for PVC conduits & white lead for metal conduits.

#### 1.7. **SWITCH-OUTLET BOXES AND JUNCTION BOXES**

All boxes shall conform to Indian Standards IS: 5133(Part-1)-1969 (Specification for boxes for enclosure of Electrical accessories) with the latest amendments. All outlet boxes for switches, sockets & other receptacles shall be fabricated from 1.6mm thick mild steel sheets duly painted with rust proof paint (zinc passivated) as called for, having smooth external & internal surfaces to true finish. Junction boxes and outlet boxes in contact with earth or installed in areas exposed to the weather shall be of 2mm thick mild steel and painted. Where called for, outlet boxes for receiving switches, telephone outlets T.V. outlets, power plugs etc. shall be fabricated to prove shape and size to suit the cover plates of approved make for different utilities. The cover plates shall be of best quality Hylam sheets or ISI grade Urea Formaldehyde Thermosetting insulating material which shall be both mechanically strong and fire retardant, as approved by the Consultant. Proper supports shall be provided in the outlet boxes to fix the cover plates of switches as required. Separate screwed earth terminal shall be provided inside the box for earthing purpose. All boxes shall have adequate number of knockout holes of



required diameter for conduit entry. Where called for outlet boxes for receiving switches and fan regulators in one box, shall be fabricated to approved shape and size to accommodate fan regulators and switches to be fixed on grid plates. These boxes shall be covered with Hylam sheets or ISI grade Urea Formaldehyde Thermosetting insulating material which shall be both mechanically strong and fire retardant. All junction boxes pull boxes and outlet boxes shall be provided with sheet cover Urea Formaldehyde Thermosetting insulating material. The box cover shall be secured to the box with adequate number of round head brass screws of approved make. Outlets exposed to the weather shall be fully weather tight, complete with rubber gasketed covers, glass where used shall be fully heat resistant for the duty. The outlet boxes shall be painted with two coats of bitumastic paint before they are fixed in position. All Outlet boxes fixed in concrete/recessed in wall shall be of a minimum depth of 55mm.

**1.8. INSPECTION BOXES**

Rust proof (Zinc passivated) inspection boxes of 1.6mm thick mild steel sheet and of required size, having smooth external and internal finish shall be provided to permit periodical inspection and to facilitate removal and replacement of wires when required. Inspection boxes shall be mounted flush with ceiling/walls finished surface and shall be provided with screwed covers of Urea Formaldehyde Thermosetting insulating material sheet cover secured to the box with brass screws. Adequate holes shall be provided for ventilation in the inspection box covers.

**1.9. CONDUCTORS**

FRLS PVC insulated multistrand copper conductor wires of 1100 Volts grade shall be used for three phase distribution and FRLS PVC insulated multistrand copper conductor wires of 1100 V grade shall also be used for Single phase distribution and shall conform to IS : 694 -1964 with the latest amendments and shall be ISI marked.

**1.10. BUNCHING OF WIRES**

Wires carrying current shall be so bunched in the conduit that the outgoing and return wires are drawn into the same conduit. Wires originating from two different phases shall not be run in the same conduit.

**1.11. DRAWING OF CONDUCTORS**

The drawing and jointing of copper conductor wires shall be executed with due regard to the following precautions, while drawing insulated wires into the conduits. Care shall be taken to avoid scratches and kinks which cause breakage of conductors. There shall be no sharp bends.

Insulation shall be shaved off for a length of 15mm at the end of wire like sharpening of a pencil and it shall not be removed by cutting it square or ringing.

FRLS PVC insulated copper conductor wire ends before connection shall be properly soldered (at least 15mm length) with special Cu solder for copper conductor or shall be properly crimped with copper lugs/sockets as the case may be. Strands of wires shall not be out for connecting to the terminals. All strands of wires shall be soldered at the end before connection. The connecting brass-screws shall have flat ends. All looped joints shall be soldered and connected through terminal block/connectors. The pressure applied to tighten terminal screws shall be just adequate, neither too much nor too less. Conductors having nominal cross-sectional area exceeding 6 Sq mm shall always be provided with cable sockets.

At all bolted terminals, brass flat washer of large area and approved steel spring washers shall be used. Brass nuts and bolts shall be used for all connections.

Only certified wiremen and cable jointers shall be employed to do jointing work. All wire shall bear the manufacturer's label and the voltage grade at one-meter intervals for the full length of coil and shall be brought to site in new and original packages.

The sub-circuit wiring for points shall be carried out in looping system and no joint shall be allowed in the length of the conductors. No wire shall be drawn into any conduit, until all work of any nature, that may cause injury to wire is completed. Care shall be taken in pulling the wires so that no damage occurs to the insulation of the wire. Before the wires are drawn into the conduits the conduits shall be thoroughly cleared of moisture, dust, and dirt or any other obstruction by Drawing dry cloth through the conduits. The minimum size of FRLS PVC

insulated stranded copper conductor wire for all sub circuit wiring for lights, exhaust fans, ceiling fan and 5A Light sockets points shall be 1.5 Sq mm. In case of power circuit not more than two 15 Amp power outlets shall be grouped in one circuit, wiring for the first power outlet shall be carried out with FRLS PVC insulated 6.0 sq mm copper conductor wires. Wiring for the second power outlet shall be carried with FRLS PVC insulated 4.0 sq mm copper conductor wires. All power outlets shall be connected with 4.0 sq mm FRLS PVC insulated copper conductor wires to the earth terminal of outlet. Separate circuit shall run with FRLS PVC insulated 4.0 sq mm copper conductor wires for water heaters, kitchen equipment, window Air conditioners and similar outlets at locations as shown on drawings.

The minimum size of wire from final distribution board to first tapping point in the circuit shall be 2.5 Sq mm FRLS PVC insulated stranded copper conductor wires. Circuit shall not have more than a total of 8 points of fans, 5A Light sockets and Light points and its load shall not exceed 800 watts. Not more than two power circuits shall be drawn through the same conduit. Separate earth wire shall run for each circuit. In case two circuits of the same phase are running in the same conduit then a common earth wire is permissible. The size of earth wire for all the light points, ceiling fans, exhaust fans, light sockets, outlet boxes etc. shall be 1.5 sq mm FRLS PVC insulated copper conductor wires.

#### 1.12. JOINTS

All joints shall be made at main switches, distribution boards, socket outlets, lighting outlets and switch boxes only. No joints shall be made inside conduits and junction boxes. Conductors shall be continuous from outlet to outlet. Joints where unavoidable, due to any specified reasons, prior permission in writing shall be obtained from the Consultant before making such connections.

#### 1.13. MAINS AND SUB-MAINS

Mains and sub-mains wires where called for shall be of the rated capacity and approved make. Every main and sub-main shall be drawn into an independent adequate size conduit. Adequate size draw boxes shall be provided at convenient locations to facilitate easy drawing of the mains and sub-mains. An independent earth wire of proper rating shall be provided. The earth wires shall run along the entire length of the mains and sub-mains. The earth wires shall be fixed to conduits by means of suitable copper clips at not more than 1000mm distance. Where mains and sub-main cables are connected to switch gears, sufficient extra length of sub-main and main cable shall be provided to facilitate easy connections and maintenance.

#### 1.14. LOAD BALANCING

Balancing of circuits in three phase installation shall be planned before the commencement of wiring, shall be got approved by the Consultant and shall be strictly adhered to.

#### 1.15. COLOUR CODE OF CONDUCTORS

Colour code shall be maintained for the entire wiring installation; red, yellow, blue for three phases and "off" circuit black for neutral and green for earth (or bare earth wire)

Telephone Multicore cables shall be of approved make and shall conform to following specifications.

- i) Type of conductor .... Electrolytic Annealed Tinned Cu conductor. (ATC)
- ii) Diameter of Conductor ... 0.61 mm dia uniform (minimum size)
- iii) Weight of conductor .... 2.52 Kg/Km minimum. iv) Resistance of conductor at 20 degree... 60 Ohms/Km, v) Radial Thickness of PVC insulation... 0.3mm  $\pm$  0.05mm uniform
- vi) Radius Thickness of PVC sheathing ... 1.2mm uniform  $\pm$  0.2mm
- vii) Overall diameter of insulated conductor. 1.2mm uniform
- viii) High voltage Test. Able to withstand upto 500 volts D.C. up to 12 hours immersion in water.

#### 1.16 M.S. CONDUIT ACCESSORIES & CONNECTIONS:

The accessories used for M.S. conduits shall conform to Indian Standards IS: 3837-1966- (Specification for fittings for Rigid steel conduits with the latest amendments. M.S. conduits shall be joined by means of screwed or plain couplers. Where there are long runs of straight conduits, inspection boxes shall be provided at intervals as approved by the Consultant. The

threads of the pipe and sockets shall be free from grease and oil. It shall be thoroughly cleaned before making the screwed/plain joints.

Proper jointing and Cleaning materials as recommended by manufacturers shall be used for jointing and cleaning of M.S. pipes. Use M.S. couplers and connectors for M.S. pipe connections and terminations in boxes. All the joints shall be fully watertight. Junction boxes and running joints shall be provided at suitable places to allow for subsequent extensions if any, without undue dismantling of conduit system. As far as possible diagonal run of conduits shall be avoided. Junction between conduit and adapter boxes, back outlet boxes, switch boxes and the like must be provided with entry spouts and smooth M.S. bushes and M.S. Checkouts. Joints between conduit and iron clad Distribution Boards or control gear shall be affected by means of conduit couplers into each of which will be coupled smooth M.S. bush from the inside of box or case. Conduit system shall be erect and straight as far as possible. All jointing methods shall be subject to the approval of the Consultant.

**M.S. CONDUIT CONNECTIONS:**

Conduit connections for MS conduits shall be screwed metal to metal and be painted with one coat of self-etching zinc chromate primer and two coats of enamel paint. The threads and sockets shall be free from grease and oil. Connections between screwed conduit and sheet metal boxes shall be by means of a brass hexagon smooth bore bush, fixed inside the box. Checkouts to be provided on inside and outside of box and connected through a coupler to the conduit or as directed by the Consultant. The joints in the conduits shall be free of burrs to avoid damage to insulation of conductors while pulling them through the conduits. Connections between PVC and MS conduits shall be through a junction box. Direct connection between PVC and MS conduits is not allowed.

**2 CABLES**

• **GENERAL**

MV Cables shall be supplied, laid tested and commissioned in accordance with drawing specifications, relevant Indian Standards specification, Indian Electricity Act and manufacturer's instructions. The cable shall be delivered at site in original drums with manufacturers name clearly written on the drums.

• **MATERIAL**

MV CABLES : MV Cables shall be FR XLPE PVC insulated aluminium conductor armoured and unarmoured cables conforming to IS: 1554 (part I&II)-1976 & IS : 694-1977 (PVC Insulated cables for working voltages up to and including 1100 volts (second revision) with latest amendments. MV cables shall be suitable for underground use and laid in trenches, ducts, cable trays, under roads and paved areas. MV Cables shall be termite resistant and shall be of approved make.

• **JOINTS IN CABLES**

The contractor shall take care to see that all the cables are apportioned to various locations in such a manner as to ensure no straight joints in the cable run. If the straight joint in cable is unavoidable due to any specified reasons, prior permission in writing shall be obtained from the Consultant before the use of such straight joints in cable.

• **JOINTING BOXES FOR CABLES**

Cable jointing boxes shall be of appropriate size, suitable for PVC insulated cables of particular voltage ratings, and shall be manufactured by approved manufacturers.

• **JOINTING OF CABLES**

All cable joints shall be made in suitable approved cable joint boxes. Jointing of cables in the joint boxes and the filling in of compound shall be done in accordance with the best practice in trade, in accordance with manufacturer's instructions and in an approved manner. All straight Joints shall be done in epoxy mould boxes with TROPOLIC/ M-Seal resin or approved equal. All terminal ends of conductors shall be heavily soldered upto at least 50mm length.

All cables shall be jointed colour to colour and tested for insulation resistance and continuity before jointing commences. The seals of cables must not be removed until preparations for

jointing are completed. Joints shall be finished on the same day as commenced and sufficient protection from the weather shall be arranged.

- **FILLING OF EPOXY COMPOUND**

Equal quantities of resin and hardner shall be taken and mixed thoroughly by hand until the mixture is free from white patches and has uniform colour. No water, oil or any other liquid shall be added to the mixture to make it soft as this will affect the properties of the compound. The mixture shall be used within 30-40 minutes of mixing. The surface on which epoxy compound is to be used shall be free from dust, rust, oil, grease and shall be dry. No disturbance or movement of joint shall be made till the epoxy compound has completely hardened. A smooth surface can be made by rubbing a damp cloth smoothly on the compound before it sets. The joints shall be painted after it has completely hardened.

- **CABLES TERMINATION**

Cable termination shall be done in terminal cable box using cable glands and the cable ends sealed with sealing compound.

- **BONDING OF CABLES**

Where a cable enters any piece of apparatus, it shall be connected to the casing by means of an approved type of armoured clamps and gland. The clamps must grip the armouring firmly to the gland or casing, so that in the event of ground movement no undue stress is passed on to the cable conductors. The glands shall be either to the lead sheath by means of 'Plumbing Joint' as on a cone of approved materials, capable of being compressed into lead sheath. The gland or cone shall be capable of effecting a good electrical bond between both the armouring and lead of the cable and the casing.

## 2.9. **LAYING OF CABLES**

Cables shall be laid by skilled and experienced workmen using adequate rollers to minimize stretching of the cable. The cable drums shall be placed on jacks before unwinding the cable. Great care shall be exercised in laying cable to avoid forming kinks. The drums shall be unrolled, and cables run over wooden rollers in trenches at intervals not exceeding 2 meters. Cables shall be laid at depth of 750mm depth below ground level in the case of MV Cables. A cushion of sand, not less than 75mm shall be provided both above and below the cable, joint boxes and other accessories. HV and MV cables shall not be laid in the same trench and/or alongside of water main. The cable shall be laid in excavated trench 80mm layer of sand shall be spread over the cable. The cable then shall be lifted and placed over the sand bed. The second layer of 80mm sand then be spread over the cable. The relative position of the cables laid in the same trench shall be preserved and the cables shall not cross each other as far as possible. At all changes in direction in horizontal and vertical planes, the cable shall be bent smooth with a radius of bend not less than 12 times the diameter of cable. Minimum 3 M long loop shall be provided at both sides of every straight joint and 5 Meters at each end of the cable. Distinguishing marks shall be made on the cable ends for identification. Insulation tapes of appropriate voltage and in red, yellow and blue colours shall be wrapped just below the sockets for phase identification. Aluminium Labels etched with the size of cable shall be provided around the two ends of each cable.

## 2.10. **PROTECTION OF CABLES**

The cable shall be protected by placing burnt bricks over the cables 600mm wide on the top layer of sand for the full length of underground cable. Where more than one cable is running in the same trench, the bricks shall cover all the cables and shall project a minimum of 80mm on either side of the cable.

Cable under road crossings and any surfaces subjected to heavy traffic, shall be protected by running them through Hume pipes of suitable size and Heavy grade quality.

Cables under paved areas (which form part of the building) shall be protected by running them through Stoneware/Hume pipes of 150 mm dia(minimum size) one meter below road level.

## 2.11. **CABLES INSIDE BUILDINGS**

Cables inside buildings shall be laid either in masonry trenches or carried on through trays or brackets. Where cables run in ducts inside the buildings the cables shall be adequately

clamped to angle iron brackets, secured to the wall, as directed and approved by the Consultant. Where cables are suspended from ceilings, they shall be carried over troughs or trays as directed and approved by the Consultant. The supports shall be placed not more than 1.0 meter apart. All cables passing through walls below paved area, and concrete shall run through stone ware pipes or Hume pipes of adequate diameter recessed or exposed as directed. Cables running along walls shall be supported and clamped to saddles, or hanger rigidly anchored at close intervals. Clear space between parallel cables shall be equal to the diameter of the cable but not less than 50mm. Where called for cable trenches shall be filled with fine sand. The contractor shall ensure that hangers, brackets and other supporting arrangements for cables are placed in proper position at the time of building the walls, concreting slabs, etc. cutting holes or opening in concrete may be carried out only with prior permission of the Consultant.

All excavations and back fill including timbering, shoring and pumping required for the installation of the cables shall be carried out as per the drawings and requirements laid down elsewhere. Trenches shall be dug true to line and grades. Back fill for trenches shall be filled in layers not exceeding 150mm. Each layer shall be properly rammed and consolidated before laying the next layer. The Contractor shall restore all surfaces roadways, sidewalks, curbs, walls or other works cut by excavation of their original condition, to the satisfaction of Consultant.

#### **2.12. MARKERS AND WARNING PLATES**

Approved CI cables markers shall be provided along the route of the cables at every 30-meter distance and at both ends of road crossing, indicating HV cables and MV cables as applicable. Special CI markers shall be provided at all buried cable joints indicating "Electrical Cable Joints. GI plates engraving the size of cable and the place it serves shall be tied to the cable at regular intervals of 2 meters for easily identification of the cables.

#### **2.13. TESTING OF CABLES**

Prior to burying of the cables, following tests shall be carried out:

a. Insulation test between phases and phase to earth for each length of cable before and after jointing.

On completion of cable laying work and jointing the following tests shall be conducted in the presence of the Consultants.

- a. Insulation Resistance test (Sectional and Overall)
- b. Continuity Resistance Test.
- c. Sheath continuity Test.
- d. Earth Test.
- e. Physical Dimensions Test.

All tests shall be carried out in accordance with relevant Indian Standard Codes of practice and Indian Electricity Rules. The contractor shall provide necessary instruments, equipment and labour for conducting the above test and shall bear all expenses in connection with such tests. All tests shall be carried out in the presence of the Consultant / Consultant.

### **3.0 EARTHING**

#### **3.1 EARTHING**

All the non-current metal parts of electrical installation shall be earthed properly. All metal conduits, trunking, cable sheaths, switchgear, outlet boxes, distribution boards, light fittings, fans and all other parts made of metal or conductive material shall be bonded together and connected by means of specified earthing system. All earthing will be in conformity with the relevant provision of Rules 33 and 61 of the Indian Electricity Rules 1956 and Indian Standard Specifications IS:3043-1987 with latest amendments.

#### **3.2. EARTHING CONDUCTORS**

All earthing conductors shall be of high conductivity electrolytic copper of 99 % purity and shall be protected against mechanical injury or corrosion.

#### **3.3. SIZING OF EARTHING CONDUCTORS**

The cross-sectional area of copper earthing conductor shall be same as the active conductor for sizes of active copper conductor upto 4.0 sqmm and shall be half the size for 16 sq mm active copper conductor and above. All fixtures, fans, outlet boxes and junction boxes shall be earthed with 1.5 sqmm PVC Insulated copper conductor wires. All power sockets and single-phase A/C units shall be earthed with 4.0 PVC Insulated copper conductor wires. All Three phase Final Distribution Boards shall be earthed with 2 nos 4 mm dia bare copper conductor wires. The sizes of the earth continuity conductors should not be less than half of the largest current carrying conductors.

The Sub-Distribution Board shall be earthed to 2 nos 600mm x 600mm x 3mm copper plate earthing stations through 25m x 3 mm copper strips.

#### 3.4. **CONNECTION OF EARTHING CONDUCTORS**

Main earthing conductors shall be taken from the earth connections at the main switchboards to an earth electrode with which the connection is to be made. Submain earthing conductors shall run from the main switchboard to the sub-distribution boards. Final distribution boards earthing conductors shall run from sub-distribution boards.

#### 3.5. **PROHIBITED CONNECTIONS**

Neutral conductor, sprinkler pipes, or pipes conveying gas, water, or inflammable liquid, structural steel work, metallic enclosures or cables and conductors, metallic conduits and lightning protection system conductors shall not be used as a means of earthing an installation or even as a link in an earthing system. The electrical resistance of metallic enclosures for cables and conductors measured between earth connections at the main switchboard and any other point on the completed installation shall be low enough to permit the passage of current necessary to operate fuse or circuit breakers and shall not exceed 1 ohm.

#### 3.6. **PROTECTION FROM CORROSION**

Connections between copper and galvanised equipment shall be made on vertical face and protected with paint and grease. Galvanised fixing clamps shall not be used for fixing earth conductors. Only copper fixing clamps shall be used for fixing earth conductors. When there is evidence that the soil is aggressive to copper, buried earthing conductors shall be protected by suitable serving and sheathing.

#### 3.7. **EARTHING STATION**

**Plate Electrode Earthing:** Earthing electrode shall consist of a tinned copper plate not less than 300mm x 300mm x 3mm thick as called for in the Schedule. The plate electrode shall be buried as far as practicable below permanent moisture level but in any case, not less than 4.2 meters below ground level. Wherever possible earth electrodes shall be located as near the water tap, water drain or a down take pipe as possible. Earth electrodes shall not be installed in proximity to a metal fence. It shall be kept clear of the buildings foundations and in no case shall it be nearer than 2 meters from the outer face of the wall. The earth plate shall be set vertically and surrounded with 150mm thick layer of charcoal, dust and salt mixture. 20mm GI pipe shall run from the top edge of the plate to the ground level. The top of the pipe shall be provided with a funnel and a mesh for watering the earth through a pipe. The funnel over the GI Pipe shall be housed in a masonry chamber, approximately 300mm x 300mm x 300mm deep. The masonry chamber shall be provided with a cast iron cover resting over a GI frame embedded in masonry. Refer Sketch for additional details.

**Pipe Electrode Earthing:** Earthing electrode shall consist of a GI Pipe (class 'A') Indian Tube Company make or approved equal not less than 40mm dia and 4.5 meters long. GI Pipe electrode shall be cut tapered at the bottom and provided with holes of 12mm dia drilled at 75mm interval upto 2.5 meters length from bottom. The electrode shall be buried vertically in the ground as far as practicable below permanent moisture level with its top not less than 1.25 M below ground level. The electrode shall be in one piece and no joints shall be allowed in the electrode. Wherever possible earth electrodes shall be located as near water tap, water drain or a down take pipe. Earth electrodes shall not be located in proximity to a metal fence. It shall be kept clear of the building foundations and in no case shall be nearer than 2 meters from the outer face of the wall. Refer Sketch for additional details.

The pipe earth electrode shall be kept vertically and surrounded with 150mm thick layer of charcoal dust and salt mixture upto a height of 2.5 meters from the bottom. At the top of the electrode a funnel with a mesh shall be provided for watering the earth. The main earth conductors shall be connected to the electrode just below the funnel, with proper terminal lugs and check nuts. The funnel over the GI pipe and earth connection housed in a masonry chamber, approximately 350mm deep. The masonry chamber shall be provided with a cast iron cover resting over a CI frame embedded in masonry.

### **3.8. EARTH CONNECTION**

All metal clad switches and other equipment carrying single phase current, shall be connected to earth by a single connection. All metal clad switches carrying medium voltage and high voltage shall be connected with earth by two separate and distinct connections. The earthing conductors inside the building wherever exposed shall be properly protected from mechanical injury by running the same in GI Pipe of adequate size.

Earthing conductors outside the building shall be laid 600mm below the finished ground level. The over lapping in copper strips at joints where required, shall be minimum 75mm. The joints shall be riveted and brazed with copper rivets and greased in approved manner. Sweated lugs of adequate capacity and size shall be used for all termination of wires above 1 Sqmm size and bare copper wire above 2.0mm dia. Lugs shall be bolted to the equipment body after the metal body is cleaned of paint and other oily substance and properly tinned. The earth wires entering the Final Distribution Boards shall be terminated with copper sockets crimped to its ends and tightened to the terminal with the help of flat end brass screws.

### **3.9. EARTH RESISTANCE**

The earth resistivity of the soil where the earthing stations are located shall be submitted to the Consultant before the earthing work starts and get the approval of the Consultant/Owner. If the earth resistance is too high and multiple electrode earthing does/not give adequate low resistance to earth, than the soil resistivity immediately surrounding the earth electrodes shall be reduced by adding sodium chloride, calcium chloride, sodium carbonate, copper sulphate, salt and soft coke or charcoal in suitable proportions as directed by the consultants.

### **3.10. RESISTANCE TO EARTH**

The resistance of each earth system shall not exceed 1.0 ohm in the case of Medium Voltage system and 0.5 ohm in the case of High Voltage system.

## **4 TESTING**

### **• GENERAL**

On completion of the work the entire installation shall be subject to following tests:

- a) Wiring Continuity Test
- b) Insulation Resistance Test
- c) Earth Continuity Test
- d) Earth Resistively Test

Besides the above any other test specified by the local Authority shall also be carried out.

All tested and calibrated instruments for testing, labour, materials and incidentals necessary to conduct the above tests shall be provided by the Contractor at his own cost.

### **• TESTING OF WIRING**

All wiring systems shall be tested for continuity of circuits, short circuits and earthing after wiring is complete and before energising. The Test Certificates for the complete wiring shall be submitted in the Format and the Total Electrical Installation shall be got approved by the Electrical Inspector.

### **• INSULATION RESISTANCE TEST**

The insulation resistance shall be measured by applying between earth and the whole system of conductors, or any section thereof with all fuses in place and all switches closed (except in concentric wiring) all lamps in position of both poles of the installation, otherwise electrically connected together, a direct current pressure of not less than twice the working pressure (provided that it does not exceed 660 volts for medium voltage circuits) be applied. Where the supply is derived from A.C. three phase system, the neutral pole of which is

connected to earth, either direct or through added resistance, pressure shall be deemed to be that which is maintained between the phase conductor and the neutral. The insulation resistance measured as above shall not be less than 50 divided by the number of points on the circuit provided that the whole installation shall not be required to have an insulation resistance greater than one mega ohm. The insulation resistance shall not be measured between all conductors connected to one phase conductor of the supply and all the conductors connected to the middle wire or to the neutral or to the other phase conductors of the supply. Such a test shall be carried out after removing all metallic connections between the two poles of the installation and in these circumstances the insulation resistance between conductors of installation shall not be less than that specified above.

The insulation resistance between the case of frame work of housing and power appliances, and all live parts of each appliance shall not be less than that specified in the relevant Indian Standard Specifications or where there is no such specification shall not be less than half a mega ohm.

- **TESTING OF POLARITY OF NON-LINKED SINGLE POLE SWITCHES**

In a two wire installation a test shall be made to verify that all non-linked single pole switches have been fitted in the same conductor throughout, and such conductor shall be labeled or marked for connection to an outer or phase conductor or to the non-earthed conductor of the supply. In the three or four wire installation a test shall be made to verify that every non-linked single Pole switch is fitted in a conductor to one of the outer or phase conductor of the supply. The entire electrical installation shall be subject to the final acceptance of the Consultant as well as the local authorities.

#### 4.5. **EARTH RESISTIVITY TEST**

Earth resistivity test shall be carried out in accordance with Indian Standard code of practice for earthing IS: 3043:1987. All tests shall be carried out in the presence of the Consultant/Owner.

#### 4.6 **TEST CERTIFICATES**

The Electrical Installation shall be tested as per relevant Indian Standards and Test Certificate to this effect shall be submitted to the Owner. The Contractor has to get the Total Electrical Installation approved by the Electrical Inspector and the permission to energise the same shall be submitted to the Owner.

### 5 **SAFETY REQUIREMENTS**

#### 5.1 **SCOPE**

This section covers the requirements of items to be provided in the sub-station for compliance with statutory regulations, safety and operational needs.

#### 5.2 **REQUIREMENTS**

Safety provisions shall be generally in conformity with the relevant Indian Standards and I.E. Rules and Regulations. In particular the following items shall be provided.

(a) **Insulation Mats**

Insulation Mats conforming to IS: 5424-1969 shall be provided in front of main switch boards and other control equipment as specified.

(b) **First Aid Charts and First Aid Box**

Charts (one in English, one in Hindi, one in Regional language), displaying methods of giving artificial respiration to a recipient of electrical shock shall be prominently provided at appropriate place. Standard First Aid Boxes containing materials as prescribed by St. John Ambulance brigade or Indian Red Cross should be provided in each sub-station.

(c) **Danger Plate**

Danger plates shall be provided on HV and MV equipments. MV danger notice plate shall be 200mm x 150mm made of mild steel at least 2mm thick vitreous enameled white on both sides and with inscriptions in signal red colour on front side as required.

(d) **Fire Extinguishers**

Portable CO2 conforming to IS: 2878-1976 dry chemical conforming to IS 2171-1976 extinguishers shall be installed in the sub-station at suitable places as specified.



## (e) Fire Buckets

Fire buckets conforming to IS: 2546-1974 shall be installed with the suitable stand for storage of water and sand.

## (f) Toolbox

A standard toolbox containing necessary tools required for operation and maintenance shall be provided in sub-station.

## (g) Caution Board

Necessary number of caution boards as "Man online" "Don't switch on" etc. shall be available in the sub-station.

## (h) Keyboard

A key board of required size shall be provided at a proper place containing castel key, and all other keys of sub-station and allied areas.

**6.0 M V PANELS, SUB-DISTRIBUTION BOARDS & FINAL DISTRIBUTION BOARDS**

The PANELSs shall be suitable for operation on 3 phase, 4 wire, 415 Volts, 50 cycles, neutral grounded at transformer and short circuit level not less than 31 MVA at 415 volts.

The PANELS shall comply with the latest edition of relevant Indian Standards and Indian Electricity Rules and Regulations. All PANELSs shall be fabricated by the contractor by using specified components as per the specifications given below:

**6.1. CONSTRUCTION FEATURES**

The PANELSs shall be metal enclosed sheet steel cubical, indoor, dead front, floor mounting type. The distribution boards shall be totally enclosed, completely dust and vermin proof. Gaskets between all adjacent units and beneath all covers shall be provided to render the joints dust proof. PANELSs shall be preferably arranged in multitier formation. All doors and covers shall be fully gasketed with foam rubber and/or rubber strips and shall be lockable. All MS sheet steel used in the construction of PANELSs shall be 2mm thick and shall be cut to different sizes and bolted as necessary to provide a rigid support for all components. Joints of any kind in sheet metal shall be bolted type and not welded type.

All covers shall be properly fitted and square with the frame, and holes in the PANELS correctly positioned. Fixing screws shall enter into holes tapped into an adequate thickness of metal or provided with hank nuts. Self-threading screws shall not be used in the construction of PANELSs. A base channel of 75mm x 40mm x 5mm thick shall be provided at the bottom. A minimum of 200 mm between the floor of MV PANELS & Distribution board and lower most unit shall be provided. The PANELS shall be of adequate size with a provision of 20% spare space to accommodate possible future additional switchgear in addition to spare feeders.

Knockout holes of appropriate size and number shall be provided in the PANELSs in conformity with the location of incoming and outgoing cables.

PANELSs shall be provided with removable aluminum plates at top and bottom to drill holes for cable entry at site.

The PANELSs shall be suitable for IP 42 protection.

**6.2. CIRCUIT COMPARTMENTS**

Each circuit breaker, MCCB and switch fuse units shall be housed in separate compartments and shall be enclosed on all sides. Sheet steel hinged lockable door shall be duly interlocked with the ACB/MCCB/switch fuse unit in 'on' and 'off' position. Safety interlocks shall be provided for air circuit breakers to prevent the breaker from being drawn out when the breaker is in 'on' position. The door shall not form an integral part of the draw out position of the ACB. All instruments and indicating lamps shall not be mounted on the ACB compartment door. Sheet steel barriers shall be provided between the tiers in a vertical section. The Knobs for holding the cubicle door in closed position shall be spring operating rotating type and not screwed type.

**6.3. INSTRUMENT ACCOMMODATION**

Separate and adequate compartments shall be provided for accommodating instruments, indicating lamps, control contractors and control fuses etc. These shall be accessible for

testing and maintenance without any danger of accidental contact with live parts of the circuit breaker, bus bar and connections.

#### **6.4. BUS BARS & BUS BAR CONNECTION**

The bus bar and interconnections shall be of electrolytic Copper of 99.9 % purity of rectangular cross sections suitable for full load current for phase bus bars and full rated current for neutral bus bar and shall be extendible on either side. Minimum 200 Amps capacity bus bars shall be provided in the distribution boards. The bus bars and interconnections shall be insulated with PVC heat shrinking sleeves and colour coded. The bus bars shall be supported on unbreakable, nonhygroscopic insulated SMC supports at regular intervals to withstand the forces arising from short circuit in the system. All bus bars shall be provided in a separate chamber and properly ventilated. The current density of copper shall not be more than 1.6 Amps per sq.mm cross sectional area of Bus bar. If Aluminium bus bars are provided the current density of Aluminium shall not be more than 0.8 Amps per sq. mm cross section of Aluminium bus bar. Maximum allowable temperature for the Bus bar to be restricted to 85<sup>0</sup> C.

All bus bar connections in PANELS shall be done by drilling holes in bus bars and connecting by cadmium plated M.S. bolts and nuts. 20% Additional cross section of bus bars shall be provided in all distribution boards to cover up the holes drilled in the bus bars. Spring and flat washers shall be used for tightening the bolts.

Automatically operated safety shutters to screen the live cluster when the breaker is withdrawn from cubicle is to be provided.

All connections between bus bars and switches and between switches and cable alley terminals shall be through solid copper strips of proper size to carry full rated current and insulated with PVC heat shrinking sleeves. All the PANELSs shall be completely factory wired, ready for connection. All the terminals shall have adequate current rating and size to suit individual feeder requirements. Each feeder shall be clearly numbered from left to right to correspond with wiring diagram. All the switches and feeders shall be distinctly marked with a small description of the service installed. Minimum width of busbar Alley shall be 300 mm and that of cable alley shall be 450 mm.

#### **6.5. TERMINALS**

The outgoing terminals and neutral link shall be brought out to a cable alley suitably located and accessible from the PANELS front. The current transformer for instruments metering shall be mounted on the terminal blocks. Cable compartments shall be provided for incoming and outgoing cables with suitable bus bar extension and supports.

#### **6.6. WIREWAYS**

A horizontal wire way with screwed covers shall be provided at the top to take interconnecting control wiring between different vertical sections.

#### **6.7. CABLE COMPARTMENTS**

Cable compartment of adequate size shall be provided in the PANELSs for easy termination of all incoming and outgoing cables entering from bottom or top. Adequate proper supports shall be provided in cable compartments to support cables. All incoming and outgoing switch/MCCB's terminals shall be brought out to terminal blocks in the cable compartment. The switch board shall have in each PANELS thermostatically controlled space heaters/ventilation fans.

#### **6.8. METERS**

All meters shall be housed in a separate compartment and accessible from front only. Lockable doors shall be provided for the metering compartment. The details of other meters and indicating lamps are as described in each switch board and neutral selector switch of appropriate range and scale. Wiring for meters shall be colour coded and labeled with approved plastic ferrules for easy identification. All meters shall be digital.

#### **6.9. CURRENT TRANSFORMERS**

Where ammeters are called for CT's shall be provided for current measuring more than 60 Amps. Each phase shall be provided with separate current transformer of accuracy class I and

suitable V.A. Burden for operation of associated metering and Relays. Current transformers shall be in accordance with IS:2705-1964 as amended upto date and Cast Resin Type. Tape wound CTS are not acceptable. The name plate of CT's. Shall be fixed in such a way it can be easily readable without dismantling.

**6.10. INDICATING PANELS AND METERING EQUIPMENT**

All meters and indicating instruments shall be accordance with relevant Indian Standards. The meters shall be flush mounted and drawout type. Indicating lamps shall be neon type and of low burden. Indicating lamps shall be backed up with fuses of 5 Amps and toggle switch.

**6.11. EARTHING**

Copper earth bars of 25mm x 3mm shall be provided for all PANELS for the full length and connected to the framework of the PANELS.

Provision shall be made for connection from this earth bar to the main earthing bar on both sides of the PANELS.

**6.12. PAINTING**

All sheet steel work shall undergo a process of degreasing pickling in acid, cold rinsing, phosphating, passivating and then sprayed with a high corrosion resistant primer. The primer shall be baked in an oven. The finishing paint treatment shall be by powder coating.

**6.13. LABELS**

Engraved anodized aluminium labels shall be provided on all incoming and outgoing feeder switches. Circuit diagram showing the control wiring shall be pasted on inside of the PANELS door and covered with transparent laminated plastic sheet. The Label shall indicate the name of the feeder, the specific area it is feeding, ampere rating and the cable size it is receiving. The Labels shall be provided on the backside of the PANELS in case of back access.

All the PANELSs shall be subject to tests specified in relevant Indian Standards and test certificate shall be furnished.

**6.14. SHOP DRAWING**

Before fabricating the PANELSs the contractor has to submit shop drawing showing the general arrangements, bill of materials and the wiring diagram for all the PANELSs to the Consultant and get approval from the Consultant.

**6.15. INSPECTION**

At all reasonable times during production and prior to shipment of equipment the contractor shall provide and secure for Consultant/ Owners representative every reasonable access and facility at their plant for inspection.

**6.16. TEST CERTIFICATES**

Testing of PANELSs shall be carried out at factory and at site as specified in Indian Standards. The test certificates for the tests carried out at factory shall be submitted in duplicate.

**6.17. MINIATURE CIRCUIT BREAKER (MCB)**

Miniature circuit breaker shall be quick make and break type and confirm with Indian Standards IS : 8828 – 1978 ( Specifications for Miniature Air Break Circuit breakers for voltage not exceeding 1000V) The housing of MCB's shall be heat resistant and having a high impact strength. The fault current of MCB's shall not be less than 9000 Amps at 230 volts. The MCB's shall be flush mounted and shall be provided with trip free manual operating mechanism "ON" and "OFF" indications.

The MCB contacts shall be silver nickel and silver graphite alloy coated with silver. Proper arc chutes shall be provided to quench the arc immediately. MCB's shall be provided with magnetic fluid plunger release for over current and short circuit protection. The overload or short circuit devices shall have a common trip bar in the case of DP and TPN Miniature circuit breakers. The MCB shall be tested and certified as per Indian Standards prior to installation.

**6.18. LV MCCB (Moulded Case Circuit Breakers)**

**6.18.1 General**

Moulded case circuit breakers shall be incorporated in the switch board wherever specified. MCCB shall conform to the latest IEC 60947-Part 1&2 & IS 13947:1993 in all respects.

- They shall be of Category A with a rated service breaking capacity (Ics) rating.

- MCCBs shall be available in fixed or plug-in/withdrawable versions as well as in 3-pole and 4-pole versions. For plug-in/withdrawable versions, a safety trip shall provide advanced opening to prevent connection and disconnection of a closed-circuit breaker.
- MCCBs shall be designed for both vertical and horizontal mounting, without any adverse effect on electrical performance. It shall be possible to supply power either from the upstream or downstream side
- MCCBs shall provide class II insulation (according to IEC 60664-1 standard) between the front and internal power circuits.
- Rated insulation voltage shall be 750V AC (50/60 Hz).
- The circuit breaker shall comply with the isolation function requirement of IEC 60947-2 section 7.1.2 to marked as suitable for isolation/disconnection to facilitate safety of operating personnel while the breaker is in use.
- All MCCBs required as per BOQ shall have Ics – rating not Icu rating.

#### **6.18.2 Construction**

- For maximum safety, the power contacts shall be insulated in an enclosure made of a thermosetting material from other functions such as the operating mechanism, the case, the trip unit and auxiliaries.
- The operating mechanism of MCCBs shall be of the quick-make, quick-break type with fault tripping overriding manual operation. All poles shall operate simultaneously for circuit breaker opening, closing and tripping
- MCCBs shall be actuated by a toggle or handle that clearly indicates the three positions: ON, OFF and TRIPPED in order to ensure suitability for isolation complying with IEC 60947-2
- The operating mechanism shall be designed such that the toggle or handle can only be in OFF position if the power contacts are all actually separated, in OFF position, the toggle or handle shall indicate the isolation position. Isolation shall be provided by a double break on the main circuit
- MCCB shall be equipped with a “push to trip” button in front to test operation and the opening of poles.

#### **6.18.3 Current Limiting, Discrimination & Endurance**

- MCCBs shall comprise a device, designed to trip the circuit-breaker in the event of high-value short-circuit currents. This device shall be independent of trip unit.
- The electrical endurance of MCCBs, as defined by IEC 60947-2 standard, shall be at least equal to 3 times the minimum required by the standard
- The MCCB shall employ maintenance free double break contact system to minimize the let-through energies and capable of achieving discrimination up to the full short circuit capacity of the downstream MCCB. The manufacturer shall provide both the discrimination tables (with test certificates) and let-through energy curves.

#### **6.18.4 Accessories**

1. MCCB shall be provided with the following accessories, as specified in schedule of quantities.
  - i) Under voltage trip
  - ii) Shunt trip
  - iii) Alarm switch
  - iv) Auxiliary switches

All the accessories shall be rated for continuous operation. These Auxiliaries shall be common for the similar type and range of MCCBs.

It should be possible to fit MCCBs with a motor mechanism for electrically controlled operation.

#### **6.18.5 Interlocking**

Moulded, case circuit breakers shall be provided with the following interlocking devices.

- a) Extended door handle.
- b) Handle interlock to prevent unnecessary manipulations of the breaker.
- c) Door interlock to prevent the door being opened when the breaker is in ON position.
- d) Defeat-interlocking device to open the door even if the breaker is in ON position.

The MCCB shall be current limiting type and comprise of quick make – Break switching mechanism. MCCBs shall be capable of defined variable overload adjustment. All MCCBs shall have adjustable short circuit pick-up.

The trip command shall override all other commands.

#### **6.18.6 Protection Functions Wherever Specified**

- All the MCCBs shall be with microprocessor-based trip units with adjustable Overload & Short circuit protection. Earth fault/Earth leakage protection shall be provided in the MCCB.
- Trip units shall be fully interchangeable type and it should be possible to upgrade the trip unit anytime without any modifications in the installation.
- In case of overload, Pre alarm indication shall be provided on the MCCB.
- Trip units shall be adjustable, and it shall be possible to fit lead seals to prevent unauthorized access to the settings.
- Trip units shall comply with appendix F of IEC 60947-2 standard (measurement of rms current values, electromagnetic compatibility, etc.)
- Protection settings shall apply to all circuit breaker poles.
- Trip units shall be equipped with Thermal memory feature to reduce the stress on the installation in case of repetitive overloads.
- All electronic components shall withstand temperatures up to 125 °C.

#### **6.18.7 Testing**

- a) Original test certificate of the MCCB as per IEC 60947-1 &2 or IS13947 shall be furnished.
- a. Pre-commissioning tests on the switch board PANELS incorporating the MCCB shall be done as per standard specifications.

### **7 FIRE DETECTION AND ALARM SYSTEM:-**

#### **7.1 SCOPE**

The scope of this section covers design, manufacturers, supply, installation, connecting, testing and commissioning of conventional type fire detection and alarm system.

The work include supply, installation, testing and commissioning of:

- a. M S conduit work with all accessories.
- b. Complete wiring in existing concealed/surface conduits
- c. Photoelectric type smoke detectors.
- d. Rate of rise cum fixed temperature heat detectors.
- e. Manual alarm stations.
- f. Response indicators.
- g. Main control and indicating panel/zonal panel.

A high degree of operational safety, high quality and well-designed detectors, signal panels and auxiliary equipment shall be accepted. Supplier shall confirm that the electronic components used in alarm and indicating panels are of standard manufacturers and are approved type, also the name of the manufacturer shall be indicated.

The Contractor shall obtain clearance and approval form the Local Fire Authorities, the insurance company ensuring the building or any other agencies whom approval is required.

#### **7.2 STANDARDS**

For Spacing of detectors	BS	:	Code of Practice CP 1019, Section 2.7
For sensitivity of smoke detector	BS	:	5446 - 1977
For control and indicating panel	IS	:	2189 – 1988
For smoke Detector	IS	:	11360 - 1985
For Heat Detector	IS	:	2175 – 1988

### 7.3 OPERATING VOLTAGE

220 volts AC + 10% 50 cycles (single phase) and 24 volts DC +- 10%

### 7.4 DETECTORS IN GENERAL

#### 7.4.1 COMPATIBILITY

All automatic fire detectors shall be interchangeable without requiring different mounting bases nor alternations in the signal panel.

#### 7.4.2 RESPONSE SPECTRUM

Combustion gas detectors shall respond to both visible and invisible aerosols, size and colour of the aerosols shall not have a decisive influence on the response of the detector.

#### 7.4.3 SENSITIVITY

On average, 30 mgr of burned material per cu.m (as measured in a 1 cu.m chamber) shall release an alarm.

#### POWER CONSUMPTION

Each detector shall use the minimum of power, for economic circuits, so that it shall be possible to connect atleast 20 detectors per zone. Distance upto 1000 meters from detector to signal panel shall not influence the number of detectors per zone.

#### BUILT-IN-RESPONSE INDICATOR

Each detector shall incorporate indicator "LED" at the base of the detector which shall light up on actuation of the detector to locate the detector which is operated. The detector shall not be affected by failure of the response indicator lamp.

#### RESPONSE INDICATORS

It shall be possible to provide a secondary response indicator for the detector outside the closed room.

#### MAINTENANCE

All detectors shall be fitted either with plug-in system or bayonet type connections only, from the maintenance and compatibility point of view.

#### CONSTRUCTION

The detector shall be vibration and shock proof. When disassembling for cleaning purpose, its components must not be damaged by static over voltage.

#### ATMOSPHERIC AND THERMAL DISTURBANCES

The detector shall also be designed as to be practically immune to environmental criteria such as air currents, humidity, temperature fluctuations, pressure and shall not release false alarm.

#### CONTINUOUS OPERATION

An alarm release shall not affect a detector's good functioning. After resetting the alarm, the detector shall resume operation without re-adjustment of any kind.

### DAPTABILITY TO AMBIENT CONDITIONS

Detectors shall be designed for adaptability to humid and explosion endangered locations.

## 18 PHOTOELECTRIC SMOKE DETECTORS

Smoke detectors shall connect with two wires to one of the Fire Alarm Panel Loops. The detectors shall use the photoelectric (light-scattering) principal to measure smoke density and shall, on command from the control panel, send data to the panel representing the analog value for smoke density. The detectors shall be ceiling mounted type and shall include a twist-lock base.

The detectors shall provide dual alarm and power LEDs. Both LEDs shall flash under normal conditions, indicating that the detector is operational and in regular communication with the control panel. Both LEDs may be placed into steady illumination by the control panel; indicating that an alarm condition has been detected. An output connection shall also be provided in the base to connect an external remote alarm LED.

The area covered by each smoke detector shall be as per IS-2189.

Detectors shall be suitable for an operating temperature 0 degree C to 55 degree C and Relative humidity of 0% to 95%.

Detectors shall be suitable for a supply voltage of 17 to 28 V DC without affecting the sensitivity.

The detector shall have the approval of UL/FM/VDS/LPC only.

- **THERMAL DETECTORS**

Thermal detectors shall connect with two wires to one of the Fire Alarm Panel loops. The detectors shall use an electronic detector to measure thermal conditions caused by a fire and shall, on command from the control panel, send data to the panel representing the level of such thermal measurements. The detectors shall be ceiling-mounted type and shall include a twist-lock base.

The detectors shall provide dual alarm and power LEDs. Both LEDs shall flash under normal conditions. Both LEDs may be placed into steady illumination by the control panel, indicating that an alarm condition has been detected.

Detectors shall be suitable for an operating temperature 0 degree C to 22 degree C and relative humidity of 0% to 95%.

Detectors shall be suitable for a supply voltage of 17 to 28 V DC without affecting the sensitivity.

The detector shall have the approval of UL/FM/VDS/LPC only.

## 7.6 **MANUAL CALL STATIONS**

Manual Call stations shall be provided to connect to the Fire Alarm Panel loops.

Manual stations shall be constructed of high impact LEXAN sheet with clearly visible operating instructions provided on the cover. The word FIRE shall appear on the front of the stations in raised letters. Press/back stations with reset table capacity shall be acceptable.

Stations shall be suitable for surface mounting as shown on the plans, or semi-flush mounting, and shall be installed not less than 42 inches, nor more than 48 inches above the finished floor unless otherwise specified by applicable building codes.

## 7.7 **RESPONSE INDICATOR**

Response indicator shall be LED (light emitting diode) type and shall indicate when a detector senses the fire.

## 7.8 **REPEATER PANEL**

Repeater panels are to be provided at remote location for monitoring the health of FAS. It should have 2-line 40 inches character display along with CEO status indicator. Battery backup shall be provided as an in-built feature and all information will be presented in clear English language. It shall be suitable for operation from 0 degree C to 49 degree C and shall be flush mounted.

#### 7.9 **ELECTRONIC HOOTERS**

All Hooters should be able to provide at least a minimum of 3 different tones, which should be user configurable. The minimum decibel level of each hooter should be 90db at 1 mtr. All hooters should be UL/FM listed.

The Electronic Hooters shall be housed in MS enclosure of 1.5 mm sheet metal.

The Hooters shall be with built on oscillator & amplifier.

The Hooters shall give wailing sound whenever it received 24 V supply from panel on receipt of Fire signal.

The MS box shall be painted with Fire Red (Power Coated)

#### 7.10 **MAIN FIRE ALARM CONTROL PANEL**

Control Panel

The control cabinet shall be dust proof and shall be provided with a glass door with lock and key to prevent tampering by unauthorized persons.

The control circuit shall consist of glass epoxy (PCB) printed circuit board, silver plated and treated with protective layer of special lacquer for protection against corrosion.

The alarm circuitry shall be 100% solid state without the use of any relays anywhere in zone card.

The zone cards shall be modular and interchangeable.

Every zone shall have individual control for test acknowledge and any zone shall be isolated without effecting the working of the other zones in the panel.

Sounder silencing control shall be provided which shall remain in visual indication at the same time making the panel from to receive alarm from any other zone without the need for resetting the entire panel.

Silencing switches/push buttons – the system shall be so designed that once an alarm has been given it shall continue till the alarm sounder is switched off. The silencing switches/push buttons in their 'OFF' position shall give an indication of this fact on the main control panel or transfer the alarm signal to supervisory sounders under the supervision of the responsible person so that they may put use of the smallest number of call points. Operation of silencing switch shall not prevent sounding of alarm from any other zone simultaneously.

Central control and indicating panel shall be suitable for conventional Fire Detection and Alarm System and shall comply with IS:2189-1988.

Control panel shall support the following Fire-Detection components.

Smoke Detectors

Detectors (Both fixed & rate of temperature rise type)

Manual Call Stations

System shall be completely backed up against Mains failure for at least 8 hours and shall be suitable for the following types of batteries.

Lead acid Maintenance free.



Lead acid non-maintenance free  
 Lead acid semi-maintenance free  
 Nickel Cadmium.

System shall be self-diagnostic and shall cover the following:  
 Components/Modules of the fire panel.  
 Faulty detectors  
 Missing detectors  
 Open circuit short circuit conditions of the detector cable.  
 Suitable indication shall be given on the panel.

Zone wise annunciation of alarm by using:  
 Buzzer Sounders

#### 7.11. **BATTERY**

Suitable rating ampere Hours 24 Volts DC sealed maintenance free batteries shall be provided for Fire Detection and Alarm System. The battery rating is indicative only. It shall be sized by bidder to cater to all momentary and short time loads in addition to supplying the continuously rated loads for a duration of 8 hours. However minimum size shall be 65 AH.  
 Battery Charger

Bidder shall furnish the battery charging system complete with all necessary accessories such as transformer, rectifier, switches, fuses, starters, contactors, ammeter, voltmeter, protections and other, devices for trouble free operation.

Construction features

Housing of battery charger shall be 2 mm thick CRCA steel sheet cabinet for indoor installation and shall be floor mounted type. The cabinet shall be folded and braced as necessary to provide a rigid support for all components. Louvers shall be provided in the cabinet for ventilation. PVC sheets of 3 mm thick shall be provided on the selves on which the batteries are to be placed.

Input

240 volts AC 50 cycles, single phase with tapings of 0-200-220-240-260 volts on the primary side of the transformer.

Output

DC output shall be 24 volts. DC bridge rectifier shall be of silicon type, having full wave rectification. Suitable contactor, relay, reset shall be provided as required.

#### 7.12 **CABLES**

All PVC insulated FRLS copper conductor stranded cables shall be 650 volts grade and shall generally conform to IS-1554-1988 and meet the signal cabling requirement of the system manufacturer.

Strands of cables shall not be cut to accommodate & connect to the terminals. Terminals shall have sufficient cross-sectional area to take all the strands.

Cables shall be laid by skilled and experienced workmen using adequate rollers to minimize stretching of the cable. The cable drums shall be placed on jacks before unwinding the cable. Great care shall be exercised in laying cables to avoid forming kinks. At all changes in direction in horizontal and vertical planes, the cable shall be bent smooth with a radius as recommended by the manufacturers. All cables shall be laid with minimum one diameter gap and shall be clamped at every metre and shall be tagged for identification with aluminium tag and clamped properly. Tags shall be provided at both ends and all changes in directions both sides of wall and floor crossings. All cable shall be identified by embossing on the tag the size of the cable, place of origin and termination.

These shall be measured on linear basis including the fittings required like, end termination junction box.

### 8.3 PUBLIC ADDRESS DEVICES

#### 8.3.1 Speakers:

All speakers shall operate on 25 VRMS or with field selectable output taps from 0.5 to 2.0 Watts.

Speaker in corridors and public spaces shall produce a nominal sound output of 84 dBA at 3 meters.

Frequency response shall be a minimum of 400 HZ to 4000 HZ.

The back of each speaker shall be sealed to protect the speaker cone from damage and dust.

- Fixed Emergency Telephone Handset

The telephone cabinet shall be painted red and clearly labeled as "Emergency Telephone". The cabinets shall be located where shown on drawings.

The handset cradle shall have a switch connection so that lifting the handset off of the cradle shall send a signal to the fire command center which shall audibly and visually indicate its on-line (off-hook) condition.

On activating the remote phone, the phone earpiece shall sound a telephone ring signal until the master handset is lifted.

The two-way emergency telephone system shall support a minimum of seven (7) handsets online without degradation of the signal.

### POINT WIRING

The rates for all point wiring items shall include:

1. Conduits, Conduit specials, bushes and other fittings concealed or exposed as called for.
2. Embedding conduit and allied fittings including the outlet boxes in walls, floors etc., during construction and/or in chases including cutting chases and making good with cement mortar as necessary in the case of concealed conduit work.
3. Providing and fixing approved fixing devices, saddles and grouting the same as required for exposed conduits.
4. Fabrication and Supply of G. I. boxes for switches, ceiling fan hooks, Exhaust fans outlet and lighting fixtures with 1.6 mm thick sheet steel.
5. Providing and fixing junction boxes with 3mm Hylam or 3mm/5mm thick Perspex sheet cover duly painted from inside to match the colour of the walls. All Junction boxes shall be MS only.
6. All fixing accessories such as clips, brass screws/brass washer's awl plugs etc.
7. All work & material necessary (including circuit wiring from DB to first tapping point of each circuit with 2.5 sq. mm wires) in complete wiring of a switch circuit of any length from the distribution board to the following via the switch:
  - a) Ceiling rose
  - b) Connector
  - c) Back plate
  - d) Socket outlet
  - e) Lamps Holder
  - f) Any other terminal outlet boxes
  - g) Ceiling fan and Exhaust fan
8. Switch, socket outlet as called for.
9. Cable/wire as required up to lamp holder.
10. All metal boxes and boards concealed, or surface mounted including those required for housing fan regulators.
11. All accessories necessary to complete wiring as specified.

12. FRLS PVC Insulated stranded Copper conductor earth wire for fixtures, switch outlet boxes and third pin of 5/15 Amps. socket to common earth.
13. Painting all exposed M.S. conduits, outlet boxes and junction boxes.
14. M.S. conduit for concealed and exposed wiring.
15. 2 mm dia G.I. pull wires in conduit work, wherever necessary.
16. The switch plate shall be made of I.S.I. grade Urea Formaldehyde Moulding powder. The base of the switches shall be made from high heat resistant phenol formaldehyde powder. The cost of switches shall include the cost of cover plates, cadmium fixing screws etc. The switches/sockets shall be rocker operated.
17. Separate Earth wire shall run along with each circuit both for power and light circuits.
18. Cutting of floor and making good for carrying conduits also.
19. Numbering of Circuits with ferrules for all circuits at both ends.
20. Providing 15 Amps capacity Bakelite terminal Blocks for terminating the phase, neutral and earth wire at each fixture location.
21. PVC insulated copper conductor wire ends before connection shall be properly soldered (at least 15 mm length) with special Cu solder for copper conductor or shall be properly crimped with copper lugs/sockets as the case may be. Strands of wires shall not be out for connecting to the terminals. All stands of wires shall be soldered at the end before connection. The connecting brass-screws shall have flat ends. All looped joints shall be soldered and connected through terminal block/connectors.
22. Provide embossing on the sockets engraving "UPS" and "RAW"

#### **CONDUITING FOR TELEPHONE & COMPUTER SYSTEM**

The rates for conduit work shall include:

1. All necessary specials and fittings.
2. M. S. inspection, junction and outlet boxes as required.
3. 3/5 mm thick Perspex sheet covers for inspection & junction boxes.
4. All fixing accessories such as clips, nails, brass screws/brass washers, etc.
5. 2 mm dia G.I. pull wires in conduit work, wherever necessary.
6. Providing and fixing approved saddle, hooks and grouting the same as required in the case of all exposed conduit work.
7. Embedding conduit and allied fittings including the outlet boxes in walls, floors etc., during construction and/or in chases including cutting chases and making good with cement mortar as necessary in the case of concealed conduit work.
8. Painting all inspection, junction and outlet boxes.
9. FRLS PVC conduit for concealed conduit wiring.
10. Painting of Hylam/perspex sheet cover from inside to suit the colour of the surrounding wall with two coats of paint.
11. Supply and fabrication of MS Zinc passivated outlet boxes.
12. The outlet cover plate for Telephone outlets shall be made of I.S.I. grade Urea Formaldehyde Moulding powder. The cost of outlets shall include the cost of cover plates, cadmium fixing screws etc. also.

13. Numbering of wires on both ends of the wires for easy identification with PVC ferrules.

### **EARTHING**

The rates for earthing items include:

1. All fixing accessories such as brass saddles, brass screws, raw plugs etc.
2. Jointing by riveting in case of copper earth strips (2 per joint) and by welding in case of GI strips.
3. Cutting chase, making holes and making good the same wherever required.
4. All masonry work including earth work for earthing stations, earthing tapes and wires.
5. Effecting adequate and proper interconnections.
6. Use of copper thimbles for all wire terminations in the Distribution Boards, switches and sockets.

### **CABLES, MAINS AND SUB-MAINS**

The rates for all items of work shall include:

1. Embedding conduits and allied fittings in walls, floors, etc., during construction and/or in chases including cutting chases and making good as necessary in the case of concealed conduit work.
2. Providing and fixing approved saddles, hangers, trays etc., and grouting the same as required for exposed conduits where called for. Providing dash fasteners for the threaded MS down rods (primer coated) used for hanging the cable trays.
3. Providing and fixing junction boxes with 5 mm thick 'Hylam' sheet covers.
4. Effecting adequate and proper connections at terminations.
5. Ensuring that provision is left in various buildings components and trenches as the work proceeds, for incorporation of cable supports at a later date.
6. Providing all fixing accessories such as clamping devices, nuts and bolts, screws etc.
7. Clamping to supports where laid in trenches.
8. Excavation of trenches and bringing the trenches to exact level as required.
9. Providing sealing compound, thimble, solder etc., at joints and terminations as called for.
10. Providing proper supports for cable terminal boxes as called for.
11. Wherever cables pass through walls, ceiling, paved area or below roads provide sleeves/ hume pipes and making good as necessary.

### **DISTRIBUTION BOARDS**

The rates for the following items of work generally include:

1. The supporting rigid steel framework.
2. 1.6 mm thick MS boxes complete with dust proof and vermin proof covers and locking arrangements, mounted flush with surfaces.
3. All fixing accessories such as dash fasteners, bolts, nuts, screws, etc. as required.
4. Building into masonry/concrete work including all necessary cutting and grouting with cement mortar 1:2.

5. Effecting adequate and proper connections.
6. Effecting proper bonding to earth.
7. Painting/lettering on switches and distribution boards the location they serve and providing on each board its circuit diagram.
8. Touching up all damaged paint over exposed work with one coat of red oxide primer and two finishing coats of approved synthetic enamel paint.
9. Main Distribution Board and Final Distribution Boards shall be fabricated by Contractor with the specified equipment.
1. Provide 6 Amps. SP MCB for Light Points Circuits, 20 Amps. SP MCB for Power Circuits and 32 Amps. SP MCB for 1.5 Ton AC Unit.

### **SUPPLY & FIXING OF LIGHTING FIXTURES**

The rate for fixing of lighting fixtures and fans shall include:

1. Receiving the fixtures from the Owner's stores and assemble the same at site and testing the fixture before fixing.
2. All components that may be required to make the installation complete in all respects such as:
  - a. Suitable length of down rod, hanger and connecting wires, where called for.
  - b. Wires for connecting the fixtures to the point through connector blocks.
  - c. All wood and metal blocks to serve as base of fixtures.
  - d. Bonding with common earth wires.
3. Drilling holes in supports where required.
4. Fixing clamps, GI bolts and nuts, clips, brass screws, dash fasteners and other fixing accessories as required, including leaving necessary provision for fixing at time of concreting.
5. Approved enamel painting for hanger rods, clamps and other components and fixing accessories as called for.
6. Testing and commissioning of all fixtures and fans after installation.
7. The lighting fixtures shall be suitable for 230 Volts, single phase 50 cycles A.C. supply system.
1. Incandescent lamps shall be 100 Watts (maximum) and fluorescent lamps shall be 18 watts and 36 watts.
9. Use G.I. suspenders and clamping to the slab with dash fasteners (4 per fitting), including turn buckle arrangements for adjustable heights for hanging. They should be the same suspenders as used for hanging the False Ceiling grid ceiling.
10. The contractor to mark the size of light fittings, speaker and fire alarm components on the false ceiling for the interior contractor to cut holes.

### **SPECIFICATIONS**

- All the works specified and provided for in the tender/ schedule and drawing or which may be required to be done in order to perform and complete any part there of shall be executed in accordance with the technical specification, workmanship, quality control, as prescribed whether enclosed/ not enclosed in this document, in the specification & codes, with up to date amendments, in the following order:-
  - a) CPWD/ DSR
  - b) IS (BIS) Codes
- All works under this contract (wherever grey cement is used) have to be executed in OPC.
- The quantities given in the tender are approximate. However, the payment shall be made on the basis of actual measurements taken on site and in conformity with CPWD Specification and BIS Codes. It is clarified that all quantities are subject to change and no claims whatsoever on this behalf shall be entertained.
- All materials used in the works shall be of their respective kind and quality specified in the tender document or approved by the SBI and/ or Architect and shall comply strictly with the requirements of the latest specifications of CPWD and Indian Standard Codes.
- The work shall be executed and measured as per metric dimensions given in the Schedule of Quantities, Drawings etc. (FPS units wherever indicated are for guidance only).

**Signature of Contractor & Seal**

## SAFETY CODE

- 1) First aid appliances including adequate supply of sterilised dressing and cotton wool shall be kept in a readily accessible place.
- 2) An injured person shall be taken to a public hospital without loss of time, in cases where the injury necessitates hospitalization.
- 3) Suitable and strong scaffolds should be provided for workmen for all works that cannot safely be done from the ground.
- 4) No portable single ladder shall be over 8 meters in length. The width between the side rails shall not be less than 30 cm (Clear) and the distance between two adjacent rungs shall not be more than 30 cm. When a ladder is used an extra mazdoor shall be engaged for holding ladder.
- 5) Every opening in the floor of a building or in a working platform be provided with suitable means to prevent to fall of persons or materials by providing suitable fencing or railing whose minimum height shall be one meter.
- 6) No floor, roof or other part of the structure shall be so overloaded with debris or materials as to render it unsafe.
- 7) Workers employed on mixing and handling material such as asphalt, cement mortar or concrete and lime mortar shall be provided with protective footwear and rubber hand-gloves.
- 8) Those engaged in welding works shall be provided with welder's protective eye-shields and gloves.
- 9) i) No paint containing leads or lead products shall be used except in the form of paste or readymade paint.  
ii) The workers should supply suitable facemasks for use when the paint is applied in the form of spray or surface having lead paint dry rubbed and scrapped.
- 10) Overalls shall be supplied by the contractor to the painters and adequate facilities shall be provided to enable the working painters to wash during the periods of cessation of work.
- 11) Hoisting machines and tackle used in the works, including their attachments, anchorage and supports shall be in perfect condition.
- 12) The ropes used in hoisting or lowering material or as a means of suspension shall be of durable quality and adequate strength and free from defects.

**PROFORMA FOR RUNNING ACCOUNT BILLS****CERTIFICATE**

The measurements on the basis of which the above entries for the Running Bill \_\_\_\_\_ were made have been taken jointly on \_\_\_\_\_ and are recorded at pages \_\_\_\_\_ of Measurement Book No. \_\_\_\_\_.

Date & Signature of  
Contractor.

Date & Signature of  
Architect's Representative  
(Seal).

Date & Signature  
of Site Engineer

The work recorded in the above mentioned measurements has been done at the site satisfactorily as per tender drawings, conditions and specifications.

**ARCHITECT**

**SITE ENGINEER / BANK's ENGINEER**



**RUNNING A/C BILL**

Name of Contractor/Agency: \_\_\_\_\_  
 Name of Work: \_\_\_\_\_  
 Sr. No. of this Bill: \_\_\_\_\_  
 No. and Date of Previous Bill. \_\_\_\_\_  
 Reference to Agreement No. \_\_\_\_\_  
 Date of Written Order to Commence. \_\_\_\_\_  
 Date of Completion as per Agreement. \_\_\_\_\_

S r. N o.	Item descri ption	Un it	Rat e (Rs. )	As per Tender		Upto Previous R/A Bill		Upto Date (Gross)		Present Bill		Remar ks
				Qty.	Amt. (Rs.)	Qty.	Amt. (Rs.)	Qty.	Amt. (Rs.)	Qty.	Am t. (Rs )	
1.	2.	3.	4.	5.		6.		7.		8.		9.

Note: 1. If Part Rate is allowed for any Item, it should be  
 Net value since  
 Indicated with reasons for allowing such a Rate.  
 Previous Bill.  
 2. If Adhoc Payment is made, it should be mentioned specifically.

Date & Signature  
 of Contractor.

**PERFORMA FOR APPLICATION BY CONTRACTOR FOR EXTENSION OF TIME**

- Name of the Contractor
- Name of the Work as given in the Agreement
- Agreement W O
- Tender Amount

- e) Date of Commencement of Work
- f) Period allowed for Completion as per Agreement
- g) Date of Completion as per Agreement
  
- h) Period for which Extension of Time has been given

**Month Year**

**Date**

- i) 1<sup>st</sup> Extension vide Bank's Letter No
- j) 2<sup>nd</sup> Extension vide Bank's Letter No
- k) 3<sup>rd</sup> Extension vide Bank's Letter No
  
- l) Reasons for which extensions have been previously given (Copies of the previous applications should be attached)
  
- m) Period for which extension is applied for and the reasons thereof including hindrances, time for extra work assigned, if any etc.

**Signature of Contractor & Seal**

**PERFORMA OF HINDERANCE REGISTER**

Name of Work : Date of State of Work :

Name of Contractor : Period of Completion:

Agreement No : Date of Completion :

Sr No	Nature of Hindrance	Date of occurrence of Hindrance	Date of which Hindrance was removed	Period of Hindrance	Signature SE / PE	Remarks
<b>1</b>	<b>2</b>	<b>3</b>	<b>4</b>	<b>5</b>	<b>6</b>	<b>7</b>

**SE = Site Engineer****PE = Project Engineer****ACCOUNT OF SECURED ADVANCE, IF ADMISSIBLE ON MATERIALS HELD AT SITE BY THE CONTRACTOR**

No.	Item	Quantity	Unit	Amount	Remarks
1	2	3	4	5	6

---

Total Value of Materials at Site

---

Secured Advance @.....% of above Value  
B

---

CERTIFIED (I) That the materials mentioned above have actually been brought by the contractor to the site of the work and no advance on any quantity of any of this item is outstanding on their security, (ii) that the materials are of imperishable nature and are all required by the contractor for use in the work in connection with the items for which rates of finished work have been agreed upon.

---

Dated Signature of

Site Engineer  
preparing the Bill

Designation\_\_\_\_\_

Dated Signature of  
Bank's Architects

Contractor's Sign

(Name of the Architects)

## LIST OF APPROVED BRANDS / MAKES FOR INTERIOR WORKS

One of the following make of the material shall be used. The contractor will have to get the sample approved from the Architect/ Bank's Engineer whose decision shall be binding on the contractor. The condition is also applicable for any material, not mentioned in the specification or schedule of work. No deviations are allowed in these even during/ after Tender.

1	Vitrified Tiles	Kajaria/ Somany/ H.R.Johnson/ NITCO
2	Ceramic wall Tiles	Kajaria/Somany/ H.R.Johnson/ NITCO
3	Ceramic floor Tiles (antiskid)	Kajaria/Somany/ H.R.Johnson/ NITCO
4	False Flooring	Unifloor/ Flexi Access Floor/ Armstrong
5	Wooden Laminated Flooring	Pergo/ Tiles/ Xylos/ Armstrong/ Vista
6	Aluminum Fittings	Jindal/ Hindalco/ MAAN
7	Aluminum Extrusion Sections	Jindal/ Hindalco/ MAAN
8	Commercial Plywood	Duro/Century/ Green/Alpro- Premium
9	Laminates (1.00mm thk.)	Greenlam / Century/ Aica/ Sonear/ Archid
10	Veneer	Duro/Century / Durian/ Sonear/ Archid/ Green
11	Drawer Sliding/ Patch Fittings	Earl Bihari (EBCO)/ Godrej/ Hettich/ Dorma
12	Floor Spring / Door Closer	Godrej / Hardwyn / Hyper/ Dorma/ Haffele
13	Triple Computer Monitor Mount/ Stand Arm	Vivo/ Dell/ HP
14	Flush Door	Century/ Archid/ Sonear
15	Texture Interior Paint	Sandtex Matt/ Dulux/ Berger/ Okios/ Asian
16	Readymade Computer Drawer	EBCO/ Hettich/ Blum
17	Paints	Asian/ Nerolac/ Berger/ Dulux
a)	Cement paint	Snowcem/ Surfacem/ Durocem
b)	Synthetic Enamel Paint	Asian/ Nerolac/ Berger/ Dulux
c)	Acrylic Emulsion Paint (Interior and Exterior)	Asian/ Nerolac/ Berger/ Dulux
18	Glazing	Modi Tuff Glass/ Triveni Glass Ltd./ Indo Asahi Glass Co. Ltd./ Saint Gobain
19	Cement	Grade 43/53 of L&T/ A.C.C./ Ambuja/ Ultratech
20	Mineral Fibre False Ceiling	Armstrong/ Indian Gypsum Board/ Gypro
21	ACP Panels/ Sheets	Alubond/ ALU Decor/ Alstrong/ Alstone
22	Acrylic Sheets	Sanmati Acrylics/Acrylic Sheet India/ Acry Plus
23	Vertical/Roller blinds	Vista/ MAC/ DACK
24	Corian	Corian/ LG/ Samsung
25	PU Paint	Asian/ Berger/ ICI
26	Wall Paper	Elemento/ Marshel
27	Solid Surface material	CORIAN or equivalent
28	Tile Adhesive	CICO, Pidilight, Unitile
29	Insulation	Lioyed Insulation, UP Twiga or equivalent
30	Rubber/ Poliurethene Foam	MM Foam, U Foam or equivalent
31	Sanitary fittings	Hindware or equivalent

**LIST OF MATERIALS OF APPROVED BRANDS FOR ELECTRICAL WORKS**

1	PVC/MS CONDUIT PIPE (ISI) MARKED	BEC / PRECISION / AKG / SETIA / CAP
2	WIRES 1100V GRADE FRLS MULTI STRANDED ONLY-ISI	FINOLEX/ SKYTON/ NATIONAL/ BONTON/ GRANDLAY/ POLYCAB / RR KEBEL/ KEI /RELISONS
3	CABLES 1100V PVC INSULATED FRLS XLPE	SKYTON/ BONTON/ NATIONAL/ GLOSTAR/ CCI / BONTON/KEI /RELISONS / GRANDLAY/ POLYCAB / FINOLEX
4	DISTRIBUTION BOARDS (DOUBLE DOOR TYPE) MCBS, MCCBS & ELCBS	LEGRAND/ L&T-HAGER/ ABB/ MDS/C&S/HPL
5	MOULAR SWITCH, SOCKET, PLATES, BOXES & OTHER ACCESSORIES (MDEL MENTIONED)	LEGRAND- Linc/ <b>Mosiac</b> / CRABTREE- <b>Athena</b> / PHILIPS- <b>Elite</b> / MK - <b>Wraparound</b> / North West- <b>Stylus</b> only /Anchor – <b>Woods</b> / <b>Viola</b> <b>Simon-Vivid-38</b> / <b>Great White-Myraha</b>
6	FLUORESCENT LUMINAIRES	PHILIPS / CROMPTON/ BAJAJ/ TRILUX/ HAVELLS / HELONIX / WIPRO / EVEREADY / HPL
7	METAL CLAD SOCKET OUTLETS	ABB/ L&T/ LEGRAND/ NORTH WEST/ C &S
8	TELEPHONE CABLE	DELTON/AMP/D-LINK / FINOLEX
9	BAKELITE SHEET	HYLAM / FORMICA
10	SOLDERLESS LUGS / FERRULES	DOWELL
11	CABLE GLANDS	COMET /GRIPWEL/ DOWEL
12	TAG BLOCK (TELE)	KRONE
13	DISTRIBUTION BOARDS (DOUBLE DOOR TYPE)	INDOASIAN/SCHNIDER/ LEGRAND/ L&T-HAGER/ ABB/ C&S/
14	FIRE ALARM SYSTEM / CCTV/ DOOR ACCESS	VINTAGE / CROMPTON
15	JOINTING KITS/ CONNECTORS	SCREWLESS WAGO & CONTROLS (I) LTD
16	METERING EQUIPMENTS	RISHAB/ AE/ CONZERV / L&T / SECURE
17	ASS/VSS	KAYACEE/ L&T
18	FANS	CG/BAJAJ/USHA/ BAJA/ HAVELLS / ORIENT
19	LAN & VOICE	AMP/ D-LINK
20	VOLTAGE STABILIZER & AC TIMER	RITLINES/ BLUE BIRD/ LOGICSTATE/ INLINE/V-GAURD/SERVOKON/SERVEL/RUPTRONICS

**NOTE:** Above makes of equipment are approved subject to their meeting the specifications. The contractor however shall seek approval of specific make from Consultant/ Bank's Engineer before commencing the work. The decision of Consultant/ Bank's Engineer shall be binding on the contractor in this respect. Any other make of the equipment not specified shall be got approved by the Bank's Electrical engineer.

**BILL OF QUANTITIES****PREAMBLE:**

TO BE READ ALONG WITH DRAWINGS.

1. RATES TO BE QUOTED BOTH IN FIGURES AND WORDS.
2. ALL PAGES TO BE SIGNED AND STAMPED BY THE TENDERER.
3. THE RATE OF THE ITEMS SHALL BE APPLICABLE FOR ANY FLOOR LEVEL/ ANY NUMBER OF FLOORS, OR ANY QUANTITY.
4. THE SPECIFICATION OF THE ITEMS SHALL BE AS PER LATEST INDIAN STANDARD CODES UNLESS OTHERWISE SPECIFIED.
5. ALL MATERIALS SHALL BE AS PER APPROVED LIST AND SHOULD BE OF 1st QUALITY UNLESS OTHERWISE SPECIFIED.
6. THE RATES ARE INCLUSIVE OF ALL DUTIES AND TAXES (EXCEPT GST) OF ALL GOVERNMENT, MUNICIPAL OR ANY OTHER STATUTORY BODY APPLICABLE FROM TIME TO TIME.
7. RATES SHALL BE FOR ITEMS COMPLETE IN ALL RESPECTS AS PER DRAWING, INSTRUCTIONS AND APPROVAL OF THE ARCHITECT/ BANK'S ENGINEER.
8. THE QUANTITIES ARE APPROXIMATE AND TENTATIVE WHICH MAY VARY DURING COURSE OF EXECUTION. THE RATES QUOTED AGAINST PARTICULAR ITEM SHALL NOT BE CHANGED WITH VARIATION IN QUANTITIES.
9. MAKING OF ANY CUTOUT / OPENING FOR ELECTRICAL / AIR – CONDITIONING WIRING / FITTING IN ANY OF THE ITEM OF FALSE CEILING, PARTITIONS, PANELING MASONRY WORK ETC. AND FINISHING EDGES JAMBS / CILLS / SOFFITS OF THE OPENING SHALL NOT BE PAID EXTRA.
10. THE TENDERER SHALL VISIT THE SITE AND SHALL SATISFY HIMSELF AS TO CONDITIONS UNDER WHICH THE WORK IS TO BE PERFORMED. HE SHALL ALSO CHECK, ASCERTAIN THE LOCATIONS OF ANY EXISTING STRUCTURES OR EQUIPMENT OR ANY OTHER SITUATION WHICH MAY AFFECT THE WORK. NO EXTRA CLAIM AS A CONSEQUENCE OF IGNORANCE OR ON GROUND OF INSUFFICIENT DESCRIPTION WILL BE ALLOWED AT A LATER DATE.
11. THE QUOTED PRICE FOR ITEMS SHALL INCLUDE ALL ACCESSORIES, CONSUMMABLES ETC. AS REQUIRED TO MAKE THE ITEM COMPLETE IN ALL RESPECTS, COMPATIBLE WITH OTHER RELATED / ASSOCIATED ITEMS AND FULLY FUNCTIONAL.
12. CONTRACTOR SHALL BE FULLY RESPONSIBLE FOR ANY ERROR, DIFFICULTY IN EXECUTION / DAMAGES INCURRED OWING TO DISCREPANCY IN DRAWINGS WHICH HAS BEEN OVERLOOKED BY HIM AND HAS NOT BEEN BROUGHT TO THE NOTICE OF THE ARCHITECT.
13. THERE ARE NUMBER OF ITEMS GIVEN IN THE TENDER WHERE IN BASIC RATES INCLUDING ALL TAXES EXPECTED HAS BEEN MENTIONED IN THE TENDER. THESE ITEMS SHALL BE PURCHASED BY THE CONTRACTOR FROM THE MARKET ONLY AFTER THE APPROVAL OF QUALITY AND RATES BY THE ARCHITECT.
14. ALL HIDDEN SURFACES OF BOARD / PLY / WOOD WORK TO BE PAINTED WITH ANTI BACTERIAL PAINT FROM NAV AIR INTERNATIONAL FR 881 (VIPER) (WHITE COLOUR AS PER MANUFACTURER'S SPECIFICATIONS ON WOOD / BOARD).
15. CONTRACTOR SHALL APPOINT TECHNICALLY QUALIFIED FULL TIME SITE SUPERVISOR TO MONITORING THE DAY TO DAY PROGRESS OF WORK AT SITE ON THEIR OWN COST.

**(Refer annexed file/section in e-tender portal for detailed Bill of Quantities)**

**AGREED AND ACCEPTED ALL THE TERMS & CONDITIONS.**

**SIGNATURE OF CONTRACTOR**

**DATE:**

**SEAL:**

# TENDER DRAWINGS

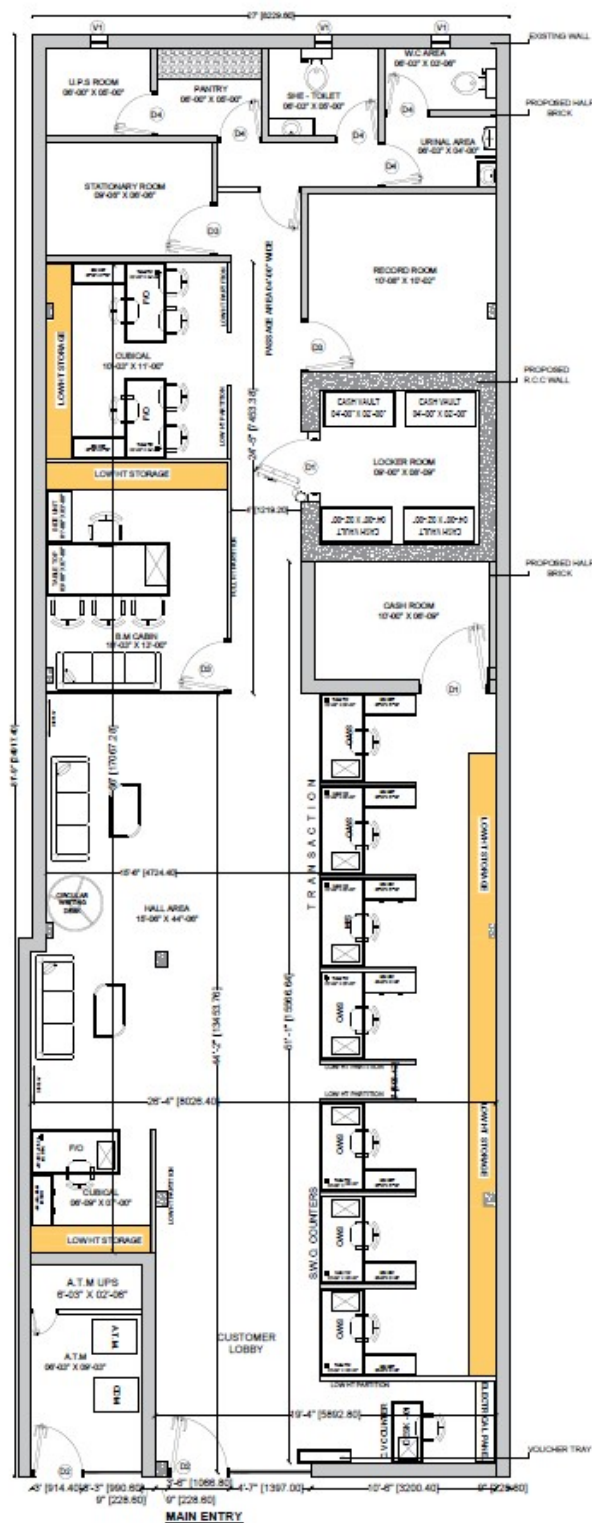

- GENERAL NOTES:**
1. This drawing is for design intent purposes only and is not to be scaled.
  2. All dimensions shown are in millimeters and are taken from the applied gridlines.
  3. All dimensions are to be verified on site by the contractor prior to manufacture and installation.
  4. Any omissions or discrepancies found shall be reported to the IO consultant / Engineer immediately for clarification.
  5. This drawing is to be read in conjunction with the relevant section of the specifications, schedules and drawings referenced.
  6. All necessary structural supports to all items including ceiling hung, wall hung, built-in units or cantilevered items shall be of adequate strength to ensure stability and shall be considered by the contractor.
  7. The contractor shall submit full shop / setting out drawings for approval (based on site dimensions) prior to commencement of any site works, or placing any orders and on manufacture of any fittings, fixtures and components shown.
  8. All work must conform to municipality regulations, national and international building code and all regulations by governing authorities.
  9. The contractor must ensure all coordination between his work, his subcontractors and the IO consultants design.
  10. All interior finishes must have a flame spread rating and smoke density rating to meet or exceed local code requirements.

**PROJECT:**  
 STATE BANK OF INDIA,  
 A.C.B. MURAD NAGAR,  
 UTTAR PRADESH.

**ARCHITECT:**  
 SHWETA JAIN  
 (C4/2014/68877 COUNCIL OF ARCHITECTS.)

**MOHAN AND ASSOCIATES**  
 Architects, Interior Designers & Valuers  
 B-6, Padma Tower -II Rajendra Place,  
 Delhi -110008  
 (Mobile) : 7428190271  
 E-mail : m.associatesdelhi@gmail.com

**LEGEND :**

OWNER	ARCHITECT
CIVIL ENGINEER	BR. MANAGER
CM(OPS)	REGIONAL MANAGER

**SUBJECT OF DRAWING:**  
 PROPOSED LAYOUT PLAN OPT - 03

DESIGN BY: Ar. SHWETA JAIN	NORTH :
PROJECT COORDINATOR : Ar. ANKIT	
SCALE : N.T.S	DATE : 05.09.2024
DRAWN BY : NAVNEET	ISSUE DT : 24.08.2024
DRAWING No. : 005	REVISION No. 01
	PAGE 02E : A3

## SAMPLE BUSINESS RULE DOCUMENT



**BUSINESS RULE DOCUMENT OF ONLINE E-REVERSE AUCTION FOR  
COMPOSITE INTERIOR, ELECTRICAL, & ALLIED WORK FOR SBI ACB MURADNAGAR BRANCH AT NEW  
DELHI ”**

BUYER NAME STATE BANK OF INDIA  
AUCTION TO BE CONDUCTED  
BY

**M/s. Antares Systems Limited,  
Bangalore,  
#24,3rd Stage, 4th Block, Basveshwaranagar,  
Bangalore- 560079, India**

Mr. Pravesh Mani  
MOB-919044314492

Website Link :

<https://www.tenderwizard.com/SBIETENDER>

**DATE & TIME OF AUCTION**

Online Auction Date: (Date and Time of E-reverse auction to be intimated after opening of technical bid and Price bid)

Auction Time: One hour

(With 6 extensions of 5 min each)

**DOCUMENTS ATTACHED (A) Business rules for Reverse Auction**

- (B) Terms & conditions of Reverse Auction
- (C) Annexure -I
- (D) Process Compliance Statement (Annexure II)
- (E) Price Confirmation Letter (Annexure III)
- (F) Price break up (Annexure IV)

**SPECIAL INSTRUCTIONS** Bidding in the last minutes and seconds should be avoided in the bidder's own interest

Neither the Service Provider nor SBI will be responsible for any lapses / failure on the part of the Contractor/Vendor, in such cases

**Important Note:** As per the new Inter-operability guidelines released by Controller of Certifying Authorities (CCA), the Secured Socket Layer (SSL) certificate for an e-Procurement application is generated on a new algorithm, SHA2. Also, the Digital Signature Certificates that will be applicable for these platforms have to be SHA2 algorithm compliant.

For the same, the users have to ensure that they have Windows XP (SP3) / Windows Vista

/Windows 7 or applicable version to be installed in the irrespective PC/Laptop. In case of Windows XP service pack 3, if you get any issue you can install the SSL patch, which is available at our download section of our e-Tender/e-Auction Portal and also at our corporate website [www.auctiontiger.net](http://www.auctiontiger.net) just below the label of "Download".

(A) Business rules for Reverse Auction:

Against this Enquiry for the subject item/system with detailed scope of supply as per our specification, SBI may resort to "REVERSE AUCTION PROCEDURE" i.e. ON-LINE BIDDING on INTERNET.

2. For the proposed reverse auction, technically and commercially acceptable bidders only shall be eligible to participate.
3. SBI will engage the services of a service provider who will provide all necessary training and assistance before commencement of on line bidding on Internet SBI

will inform the Contractor/Vendor in writing in case reverse auction, the details of service provider to enable them to contact and get trained.

4. Business rules like event date, time, start price, bid decrement, extensions, etc. also will be communicated through service provider for compliance.

5. Contractor/Vendors have to send the mail the compliance form in the prescribed format (provided by service provider) before start of Reverse auction. Without this the Contractor/ Vendor will not be eligible to participate in the event.

6. Reverse auction will be conducted on schedule date & time.

7. At the end of reverse auction event, the lowest bidder value will be known on the net work.

8. The lowest bidder has to mail the duly signed filled-in prescribed format as provided on case-to- case basis to SBI through service provider within 24 hours of auction without fail.

9. In case SBI decides not to go for Reverse auction procedure for this tender enquiry, the price bids and price impacts, if any already submitted and available with SBI shall be opened as per SBI standard practice.

10. The reverse auction will be treated as closed only when the bidding process get closed in all respects for the item listed in the tender.

(B) Terms & conditions of Reverse Auction:

SBI shall finalize the procurement of the item against this Tender through reverse auction mode. SBI has made arrangement with M/s. **Antares Systems Limited, Bangalore**, who shall be SBI's authorized service provider for the same. Please go through the guidelines given below and submit your acceptance to the same along with your Commercial Bid.

1. Computerized Reverse auction shall be conducted by SBI, on pre-specified date, while the Contractor/ Vendors shall be quoting from their own offices/ place of their choice. Internet connectivity and other paraphernalia requirements shall have to be ensured by Contractor/ Vendors themselves. In the even to failure of their Internet connectivity, (due to any reason whatsoever it may be) it is the bidders' responsibility. In order to ward-off such contingent. Situation bidders are requested to make all the necessary arrangements/alternatives such as back-up power supply whatever required so that they are able to circumvent such situation and still be able to participate in the reverse auction successfully. Failure of power at the premises of Contractor/ Vendors during the Reverse auction cannot be the cause for not participating in the reverse auction. On account of this the time for the auction can not be extended and SBI is not responsible for such eventualities.

2. ETL shall arrange to train your nominated person(s), without any cost to you. They shall also explain you all the Rules related to the Reverse Auction. You are required to give your compliance on it before start of bid process.

3. BIDDING CURRENCY AND UNIT OF MEASUREMENT: Bidding will be conducted in Indian currency & Unit of Measurement will be displayed in Online Auction.

4. BIDPRICE: The Bidder has to quote the rate as per the Tender Document provided by State Bank of India.

5. VALIDITY OF BIDS: The Bid price shall be firm for a period specified in the tender document and shall not be subjected to any change whatsoever.

6. At the end of the reverse auction, bidder has to provide the price confirmation letter & a detail break up for his lowest offer within 24 hour of

closing of auction as per the Annexure III & IV respectively.

7. Procedure of Reverse Auction

